

AGENDA
Municipal Services Committee
April 25, 2011
6:30 P.M. – Council Chambers

1. **Call to Order & Roll Call**
2. **Establishment of Quorum**
3. **New Business**
 - a. **1224 Plainfield Road:** Petitioner requests to rezone the property from R-2 Single-Family Residence to B-2 Community Shopping Center Business District, a zoning map amendment
 - b. **Ordinance** – 2011 Prevailing Wage
 - c. **Resolution** - Extend Contract with Gaffney’s Protective Maintenance Inc for Street Light Repair
 - d. **Resolution** – Execute a Contract with Tru Green for Landscape Fertilization
 - e. **Resolution** – Accept a proposal from North American Salt Company for the purchase of Rock Salt
 - f. **Resolution** – Extend a Contract with Hoving Clean Sweep, LLC for 2011 Street Sweeping services
 - g. **Resolution** – Illinois Department of Transportation authorizing the expenditure of Motor Fuel Tax funds
 - h. **Minutes** – February 28, 2011 – Municipal Services Committee
 - i. **Minutes** – April 11, 2011 – Municipal Services Committee Special Meeting
4. **Director’s Report**
 - a. Chromium 6 article
5. **Next regularly scheduled meeting** – May 23, 2011.
6. **Adjournment**

AGENDA MEMO
MUNICIPAL SERVICES COMMITTEE
MEETING DATE: April 25, 2011

Issue Statement

PZC 2011-03: **1224 Plainfield Road:** Petitioner requests to rezone the property from R-2 Single-Family Residence to B-2 Community Shopping Center Business District, a zoning map amendment.

Applicable Regulations: Zoning Ordinance: Section 5A-2-2-5: Amendments
 Zoning Ordinance: Section 5A-7-2: R-2 Single-Family Residence District
 Zoning Ordinance: Section 5A-8-3: B-2 Community Shopping Center District

General Information

Property Owner/
Petitioner: Erika Zimmerman
 8456 Charles Court
 Downers Grove, IL 60516

Property Location: 1224 Plainfield Road

PIN: 09-28-402-019

Existing Zoning: R-2 Single-Family Residential

Existing Land Use: Beauty shop, with special use approval

Surrounding Zoning and Land Use:

North: R-2 Single-Family Residential: single-family residential
South: R-2 Single-Family Residential: vacant building, former dental clinic
East: R-2 Single-Family Residential: municipal water tower
West: O Office: professional offices

Comprehensive Plan Update: Commercial

History: Ordinance O-13-80, adopted March 17, 1980, granted a special use for a beauty shop within the R-2 zoning district.

Size of Property: 35,317.5 square feet (0.81 acres)

Floodplain: Floodplain map does not show floodplain on this lot.
Natural Features: None.
Transportation: Property has frontage on Plainfield Road.

Documents Submitted

This report is based on the following information submitted to the Community Development Department by the petitioner:

1. Plat of Survey, 1 sheet, prepared by Schlaf-Sedig & Associates, April 16, 1976.

Planning Overview/ Discussion

The subject property is located on the north side of Plainfield Road, west of the Brookhaven Plaza Shopping Center and the City's water tower.

Currently, the property is zoned R-2 Single-Family Residence. The petitioner is requesting to rezone the property from R-2 to the B-2 Community Shopping Center Business District. Rezoning property changes the official Zoning Map, impacting the uses and signage permitted on the property.

The Darien Comprehensive Plan Update designates this property as Commercial. However, a specific zoning classification is not provided.

The City has granted the following zoning approvals:

- Ordinance No. O-13-80: Special use for a beauty parlor, through conversion of the single-family home. Signage restricted to 8 square feet, placed on wall of structure.
- Ordinance No. O-02-01: Variation granted to allow a monument sign in addition to the permitted wall sign.
- Ordinance No. O-03-07: Special use granted in 1980 amended to allow parking lot expansion.
- Ordinance No. O-02-08: Variation granted to allow a free-standing sign, 60 square feet in area, not to exceed 12 feet in height, and to allow wall signage of 2 square feet per linear foot of building frontage.

The character of this property, as well as the adjacent properties on Plainfield Road, is commercial, rather than residential. The size of the property limits the type and intensity of any future development on this site, such as building footprint and parking, for example. Of course, multiple parcels could be assembled to create a larger development site.

At the end of this memo is a table showing the permitted and special uses for the R-2 and B-2 zoning districts.

When considering a rezoning, the following shall be considered:

1. Existing conditions.
2. The conservation of property values.
3. The direction of building development to the best advantage of the entire community.
4. The uses to which property is devoted at the time the petition is considered.

Staff Findings/Recommendations

Staff supports the rezoning petition. The rezoning request is in line with the adopted Comprehensive Plan Update, adopted in 2002.

Therefore, staff recommends the Planning and Zoning Commission made the following recommendation to grant the rezoning petition:

Based upon the submitted petition and the information presented, the request associated with PZC 2011-03 is in conformance with the standards of the Darien City Code and, therefore, I move the Planning and Zoning Commission recommend approval of the petition as presented.

Planning and Zoning Commission Review – April 20, 2011

The Planning and Zoning Commission considered this matter at its meeting on April 20, 2011. The following members were present: Beverly Meyer – Chairperson, Donald Hickok, Gloria Jiskra, Ronald Kiefer, John Lind, Raymond Meilkus Susan Vonder Heide, Michael Griffith – Senior Planner, Elizabeth Lahey – Secretary.

Members absent: Kenneth Ritzert

Michael Griffith, Senior Planner, reviewed the staff agenda memo. He noted briefly previous zoning approvals granted to the property. He noted that rezoning the property changes the Zoning Map and

brings the property under different regulations within the Zoning Ordinance, namely the uses permitted on the property. He stated the Comprehensive Plan supports the rezoning petition, calling for the property to be commercial.

Mr. Griffith stated there is a table in the memo listing the permitted uses within the B-2 zoning district. He noted that some uses will trigger a public hearing for approval, the uses listed as special uses.

Mr. Griffith stated that two residents adjacent to the north came into City Hall with concerns over the rezoning, believing it was going to become a shopping center. He stated attempted to address their concerns, explaining the possible changes to the property. He stated those residents are not at the meeting.

Chairperson Meyer asked if more signage would be allowed.

Mr. Griffith stated that within the B-2 zoning district, one ground sign is permitted, 60 square feet in area for each face of a double sided sign, not greater than 12 feet in height, and wall signage could not exceed 2 square feet per linear foot of building frontage. He stated that the signage currently on the property likely falls into this allowance, that he did not think there could suddenly be a large increase in signage on the property.

Erika Zimmerman, the petitioner, stated they intend to keep the property as is. She stated that over the years, offices were built to her west, there was a dentist office across the street, and there is a shopping center to her east. She stated that she believes her property should be zoned for commercial.

Commissioner Lind asked about the required building setback along the northeast lot line, allowable building height, and floor area ratio.

Mr. Griffith stated if rezoned, a 40-foot building setback would be required along the north lot line. He stated the Zoning Ordinance would allow a 3-story building not exceeding 40 feet in height, with a maximum floor area ratio of 0.6. He also stated that total lot coverage could not exceed 75% of the lot area.

Commissioner Jiskra asked if they hoped the property value would increase if the property is rezoned.

Mrs. Zimmerman stated she thought the property value would increase, but that was not her motivation.

Chairperson Meyer asked if a 3-story building could be built, given parking requirements.

Mr. Griffith stated that parking requirements typically bring the size of a building down. He explained that as the building increases in size, in square footage, the amount of parking required increases. He stated typically the building is reduced in size to accommodate parking. He stated the size of the property will limit the intensity of any redevelopment of the site.

Commissioner Lind stated his concern with how the rezoning will impact the adjacent residents to the north.

Chairperson Meyer asked if there were plans to enlarge the building in 10-15 years.

Mrs. Zimmerman stated there are no plans to enlarge the building.

Commissioner Hickok stated the rezoning request falls inline with the Comprehensive Plan. He stated that when they worked on the Plan, they wanted that section of Plainfield Road to be commercial.

There was not anyone from the public to offer comments.

Without further discussion, Commissioner Jiskra made the following motion, seconded by Commissioner Kiefer:

Based upon the submitted petition and the information presented, the request associated with PZC 2011-03 is in conformance with the standards of the Darien City Code and, therefore, I move the Planning and Zoning Commission recommend approval of the petition as presented.

**Upon a roll call vote, THE MOTION CARRIED by a vote of 7-0.
(Commissioner Ritzert was absent.)**

Decision Mode

The Planning/Zoning Commission considered this item at its meeting on April 20, 2011.
The Municipal Services Committee will consider this item at its meeting on April 25, 2011.

| R-2 Single-Family Residence | B-2 Community Shopping Center |
|--|---|
| Permitted Uses: | Permitted Uses: |
| Single-family detached dwellings | Animal hospitals |
| Public, denominational or private schools, limited to elementary, junior or high schools, without boarding | Antique shops |
| Parks, playgrounds and forest preserves when publicly owned and operated | Art shops or galleries, but not including auction rooms |
| Accessory uses and buildings to the above permitted uses | Automobile parts and accessories stores |
| Home occupations | Bakeries |
| | Banks and financial institutions |
| | Barbershops |
| | Beauty shops |
| | Bicycle sales, rental and repair stores |
| | Blueprinting and copying establishments |
| | Book and stationery stores |
| | Business and office machine stores, sales and service |
| | Camera and photographic supply stores |
| | Candy and ice cream stores |
| | Carpet and rug stores, retail sales only |
| | Catering establishments |
| | China and glassware stores |
| | Clinics, medical and dental |
| | Clothing and costume rental stores |
| | Coin and stamp stores |
| | Custom dressmaking establishments |
| | Dairy product establishments |
| | Department stores |
| | Drugstores |
| | Dry goods stores |
| | Dry-cleaning establishments, not including industrial dry-cleaning plants |
| | Electrical, light fixtures and household appliance stores including radio and television sales and repair |
| | Employment agencies |
| | Equipment rental stores |

| B-2 Community Shopping Center | |
|--------------------------------------|--|
| Permitted Uses: | |
| | Frozen food stores, including locker rental in conjunction therewith |
| | Furniture stores, including upholstering when conducted as part of the retail operations and secondary to the principal use |
| | Furrier shops, including the incidental storage and conditioning of furs |
| | Garden supply, tool and seed stores |
| | General retail |
| | Gift shops |
| | Hardware stores |
| | Hearing aid stores |
| | Hobby shops, for retail of items to be assembled or used away from the premises |
| | Household appliance stores |
| | Interior decorating shops, including upholstering and making of draperies, slipcovers and other similar articles, when conducted as part of the retail operations and secondary to the principal use |
| | Jewelry stores, including watch repair |
| | Leather goods and luggage stores |
| | Locksmith shops |
| | Mail order, catalog store |
| | Millinery shops |
| | Musical instrument sales and repair |
| | Nursery schools, preschools and daycare centers |
| | Offices, professional and business |
| | Optician, retail sales |
| | Orthopedic and medical appliance stores |
| | Package liquor stores |
| | Paint, glass and wallpaper stores |
| | Pet shops |
| | Phonograph record and sheet music stores |
| | Picture framing, when conducted for retail trade on the premises only |

| | B-2 Community Shopping Center |
|--|---|
| | Permitted Uses: |
| | Secondhand stores and rummage shops |
| | Sewing machine sales and service |
| | Shoe and clothing repair stores |
| | Shoe stores |
| | Sporting goods stores |
| | Tailor shops |
| | Ticket agencies |
| | Tobacco shops |
| | Toy shops |
| | Travel bureaus and transportation ticket offices |
| | Undertaking establishments |
| | Variety stores |
| | Wearing apparel shops |
| | |
| R-2 Single-Family Residence | B-2 Community Shopping Center |
| Special Uses: | Special Uses: |
| | |
| Civic buildings and government uses | Amusement establishments, including, but not limited to bowling alleys, sports complexes, pool halls, dance halls and skating rinks, and establishments utilizing more than 4 automatic amusement devices as either: a) an accessory use to a restaurant offering complete meals, or b) an accessory use to an approved amusement establishment |
| Golf courses, not including commercially operated driving ranges or miniature golf courses | Automobile service stations, repair facilities, and car washes used in conjunction with an automobile service station |
| Nursery schools, preschools and daycare centers | Bus stations |
| Privately owned parks and playgrounds | Civic buildings and governmental uses |
| Public and private utility facilities | Drinking establishments |
| Planned Unit Developments (PUD) | Drive-in and drive-thru establishments |
| Religious institutions, including, but not limited to churches, rectories, seminaries, convents and monasteries, including dormitories and other accessory uses required for operation | Eating establishments |
| Swimming, tennis, racquet and other athletic club facilities | Eating establishments, not including entertainment or dancing |

| R-2 Single-Family Residence | B-2 Community Shopping Center |
|--|---|
| Special Uses: | Special Uses: |
| <p>Single-family homes may be converted to the following business uses: medical, dental, real estate, insurance, attorney, architect, engineer, optometrist or accountant offices, beauty parlors, barbershops, animal clinics where animals are housed only during treatment.</p> <p>The following conditions apply: the lot must front onto Cass Avenue, Plainfield Road or Route 83, and</p> <ol style="list-style-type: none"> 1. is adjacent to a lot zoned B-1; 2. is adjacent to a lot with a legal commercial non-conforming use or 3. is adjacent to a lot granted a special use under the conditions noted above. | <p>Garages for storage, repair and servicing of motor vehicles, including body repair, painting and engine rebuilding</p> |
| | Hotels and motels |
| | Motor vehicle sales |
| | Public and private utility facilities |
| | Public owned and operated parks, playgrounds and forest preserves |
| | Planned Unit Developments (PUD) |
| | Radio and television stations and studios |
| | Swimming, tennis, racquet and other athletic club facilities |
| | Theaters |
| | Wholesale establishments |
| | |
| | |

Permitted uses are those uses allowed by right.

Special uses require approval by the City Council via a public hearing process, with consideration by the Planning and Zoning Commission and the City Council’s Municipal Services Committee.

PLAT OF SURVEY

1/2 the westerly 150.00 feet of Lot 38 (as measured on the Northern and Southern lines thereof) under and Oliver's Subdivision Unit 1, a subdivision of part of the Southeast quarter of Section 16 Township 36 North, Range 11, East of the 3rd Principal Meridian, according to the plat thereof recorded November 16, 1955 as Document 290877 in Du Page County, Illinois.

Exhibit A

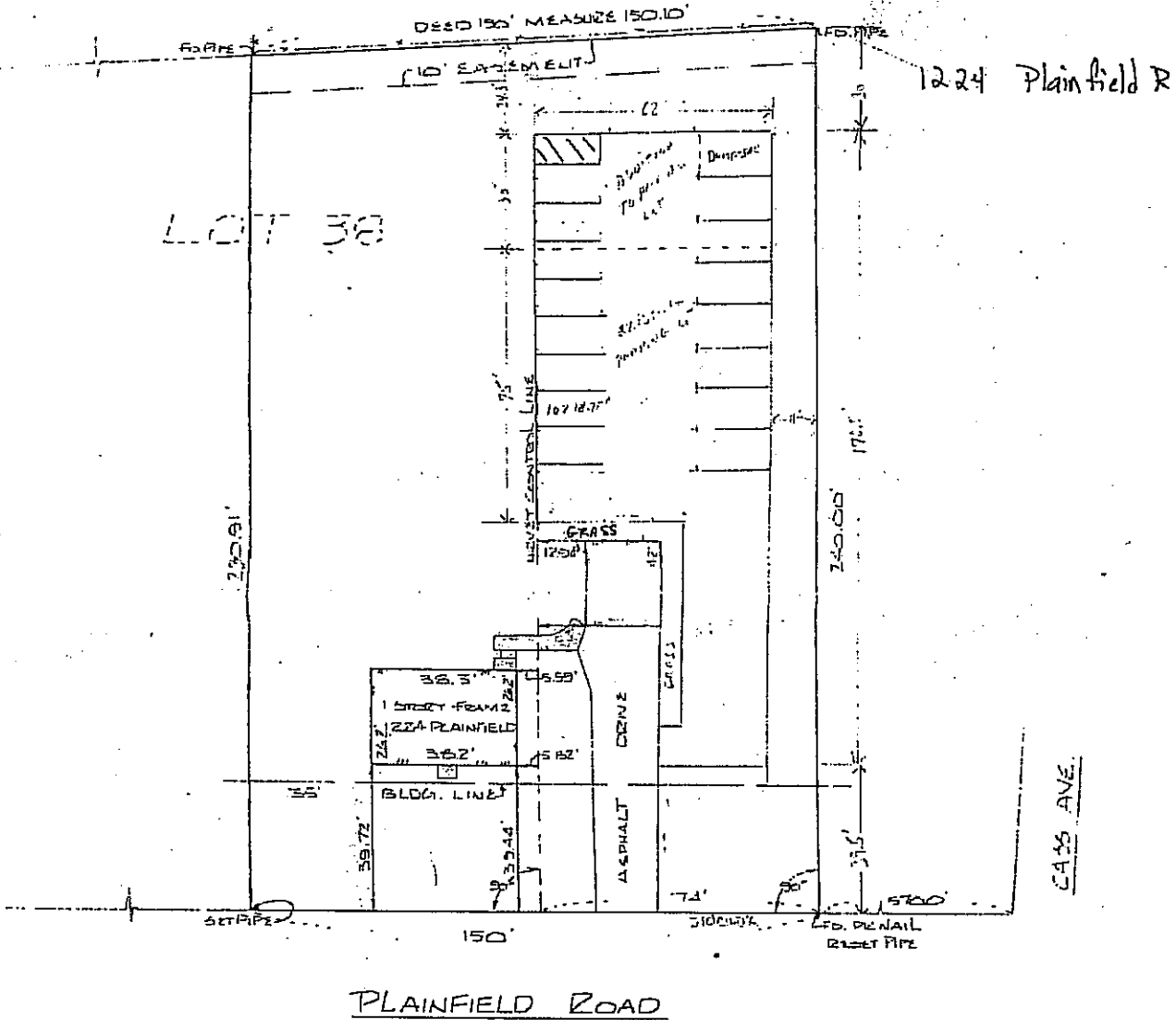

SCHLAF-SEDIG & Associates
5 North 425 Eagle Terrace
Itasca, Illinois 60143

State of Illinois)
County of Du Page)

(312) 773-1761

I hereby certify that the above described property has been surveyed, under my supervision, according to the official record and that the above plat correctly represents said survey.

Scale 1" = 30' feet

Date of Survey April 18, 1976

I hereby further certify that unless otherwise shown, the buildings on the parcel are within property lines and the adjoining improvements do not encroach on the above described property.

Mark G. Sedig
Compare the description of this plat with deed.
Refer to title policy for items of record not shown hereon.



AGENDA MEMO
Municipal Services Committee
April 25, 2011

ISSUE STATEMENT

Approving an ordinance ascertaining the prevailing rate of wages for laborers, workman, and mechanics employed on Public Works projects for the City of Darien, County of DuPage, Illinois.

BACKGROUND/HISTORY

Annually, the state law requires that municipalities ascertain the prevailing wages to be paid on Public Works projects within the community. The State of Illinois provides the last listing of the prevailing rates and it then becomes the City's responsibility to accept and publish these rates for future construction projects of the City. An ordinance has been developed, as in past years, to certify the prevailing wage rates for the coming year that has been received from the Illinois Department of Labor which is dated May 2011.

STAFF RECOMMENDATION

The State requires the annual approval of the prevailing wage rates as published by the State of Illinois and, as such, Staff recommends acceptance of these rates.

ALTERNATE CONSIDERATION

Not approving the ordinance at this time.

DECISION MODE

This item will be placed on the May 2, 2011 agenda for formal City Council consideration and approval

CITY OF DARIEN
DU PAGE COUNTY, ILLINOIS

ORDINANCE NO. _____

**AN ORDINANCE OF THE CITY OF DARIEN,
DU PAGE COUNTY, ILLINOIS, ASCERTAINING
THE PREVAILING RATE OF WAGES FOR
LABORERS, WORKMEN, AND MECHANICS
EMPLOYED ON PUBLIC WORKS OF SAID CITY**

**ADOPTED BY THE
MAYOR AND CITY COUNCIL
OF THE
CITY OF DARIEN**

THIS 2nd DAY OF MAY, 2011

**Published in pamphlet form by authority
of the Mayor and City Council of the City
of Darien, DuPage County, Illinois, this
_____ day of May, 2011.**

ORDINANCE NO. _____

**AN ORDINANCE OF THE CITY OF DARIEN, DU PAGE COUNTY, ILLINOIS,
ASCERTAINING THE PREVAILING RATE OF WAGES FOR
LABORERS, WORKMEN, AND MECHANICS
EMPLOYED ON PUBLIC WORKS OF SAID CITY**

WHEREAS, The State of Illinois has enacted “An act regulating wages of laborers, mechanics and other workers employed in any public works by the State, County, City, or any public body or any political subdivision or by any one under contract for public works,” approved June 26, 1941, codified as amended, 820 ILCS 130/1 et seq. (1993), formally Ill. Rev. Stat., Ch. 48, par. 39s-1 et seq.; and,

WHEREAS, the aforesaid Act requires that the City Council of the City of Darien investigate and ascertain the prevailing rate of wages as defined in said Act for laborers, mechanics and other workers in the locality of said City of Darien employed in performing construction of public works, for said City of Darien;

NOW, THEREFORE, BE IT ORDAINED BY THE CITY COUNCIL OF THE CITY OF DARIEN, DU PAGE COUNTY, ILLINOIS, as follows:

SECTION 1: To the extent and as required by “An act regulating wages of laborers, mechanics and other workers employed in any public works by the State, County, City, or any public body or any political subdivision or by any one under contract for public works,” approved June 26, 1941, as amended, the general prevailing rate of wages in this locality for laborers, mechanics and other workers engaged in construction of public works coming under the jurisdiction of the City of Darien is hereby ascertained to be the same as the prevailing rate of wages for construction work in DuPage County area as determined by the Department of Labor of

ORDINANCE NO. _____

the State of Illinois effective May 2011, a copy of that determination being attached hereto and incorporated herein by reference. As required by said Act, any and all revisions of the prevailing rate of wages by the Department of Labor of the State of Illinois shall supersede the Department's May determination and apply to any and all public works construction undertaken by the City of Darien. The definition of any terms appearing in this Ordinance which are also used in aforesaid Act shall be the same as in said Act.

SECTION 2: Nothing herein contained shall be construed to apply said general prevailing rate of wages as herein ascertained to any work or employment except public works construction of the City of Darien to the extent required by the aforesaid Act.

SECTION 3: The City Clerk shall publicly post or keep available for inspection by any interested party in the main office of the City this determination of prevailing rate of wages then in effect shall be attached to all contract specification.

SECTION 4: The City Clerk shall mail a copy of this determination to any employer, and to any association of employers and to any person or association of employees who have filed their names and addresses, requesting copies of any determination stating the particular rates and the particular class of workers whose wages will be affected by such rates.

SECTION 5: The City Clerk shall promptly file a certified copy of this Ordinance with both the Secretary of State Index Division and the Department of Labor of the State of Illinois.

SECTION 6: The City Clerk shall cause to be published, in a newspaper of general circulation within the area, a copy of this Ordinance, and such publication shall constitute notice that the determination is effective and that this is the determination of this public body.

ORDINANCE NO. _____

SECTION 7: This Ordinance shall be in full force and effect from and after its passage and approval as provided by law.

PASSED BY THE CITY COUNCIL OF THE CITY OF DARIEN, DU PAGE COUNTY, ILLINOIS, this 2nd day of May, 2011.

AYES: _____

NAYS: _____

ABSENT: _____

APPROVED BY THE MAYOR OF THE CITY OF DARIEN, DU PAGE COUNTY, ILLINOIS, this 2nd day of May, 2011.

KATHLEEN MOESLE-WEAVER, MAYOR

ATTEST:

JOANNE F. COLEMAN, CITY CLERK

APPROVED AS TO FORM:

CITY ATTORNEY

Du Page County Prevailing Wage for May 2011

| Trade Name | RG | TYP | C | Base | FRMAN | *M-F>8 | OSA | OSH | H/W | Pensn | Vac | Trng |
|------------------------|----|-----|---|--------|--------|--------|-----|-----|-------|-------|-------|-------|
| ===== | == | === | = | ===== | ===== | ===== | === | === | ===== | ===== | ===== | ===== |
| ASBESTOS ABT-GEN | | ALL | | 35.200 | 35.700 | 1.5 | 1.5 | 2.0 | 10.63 | 8.570 | 0.000 | 0.450 |
| ASBESTOS ABT-MEC | | BLD | | 32.290 | 0.000 | 1.5 | 1.5 | 2.0 | 10.82 | 10.66 | 0.000 | 0.620 |
| BOILERMAKER | | BLD | | 43.020 | 46.890 | 2.0 | 2.0 | 2.0 | 6.720 | 9.890 | 0.000 | 0.350 |
| BRICK MASON | | BLD | | 39.030 | 42.930 | 1.5 | 1.5 | 2.0 | 8.800 | 10.67 | 0.000 | 0.740 |
| CARPENTER | | ALL | | 40.770 | 42.770 | 1.5 | 1.5 | 2.0 | 9.840 | 9.790 | 0.000 | 0.490 |
| CEMENT MASON | | ALL | | 38.000 | 40.000 | 2.0 | 1.5 | 2.0 | 8.700 | 14.95 | 0.000 | 0.380 |
| CERAMIC TILE FNSHER | | BLD | | 33.600 | 0.000 | 2.0 | 1.5 | 2.0 | 6.950 | 8.020 | 0.000 | 0.540 |
| COMMUNICATION TECH | | BLD | | 32.650 | 34.750 | 1.5 | 1.5 | 2.0 | 7.650 | 13.98 | 0.400 | 0.490 |
| ELECTRIC PWR EQMT OP | | ALL | | 34.240 | 45.510 | 1.5 | 1.5 | 2.0 | 5.000 | 10.62 | 0.000 | 0.260 |
| ELECTRIC PWR GRNDMAN | | ALL | | 26.480 | 45.510 | 1.5 | 1.5 | 2.0 | 5.000 | 8.200 | 0.000 | 0.200 |
| ELECTRIC PWR LINEMAN | | ALL | | 41.000 | 45.510 | 1.5 | 1.5 | 2.0 | 5.000 | 12.71 | 0.000 | 0.310 |
| ELECTRIC PWR TRK DRV | | ALL | | 27.420 | 45.510 | 1.5 | 1.5 | 2.0 | 5.000 | 8.500 | 0.000 | 0.210 |
| ELECTRICIAN | | BLD | | 36.200 | 39.820 | 1.5 | 1.5 | 2.0 | 9.250 | 16.27 | 4.380 | 0.680 |
| ELEVATOR CONSTRUCTOR | | BLD | | 47.410 | 53.340 | 2.0 | 2.0 | 2.0 | 10.53 | 10.71 | 2.840 | 0.000 |
| FENCE ERECTOR | NE | ALL | | 32.660 | 34.660 | 1.5 | 1.5 | 2.0 | 10.67 | 10.00 | 0.000 | 0.500 |
| FENCE ERECTOR | W | ALL | | 43.300 | 45.460 | 2.0 | 2.0 | 2.0 | 8.140 | 17.29 | 0.000 | 0.400 |
| GLAZIER | | BLD | | 38.000 | 39.500 | 1.5 | 2.0 | 2.0 | 10.19 | 13.64 | 0.000 | 0.790 |
| HT/FROST INSULATOR | | BLD | | 43.050 | 45.550 | 1.5 | 1.5 | 2.0 | 10.82 | 11.86 | 0.000 | 0.620 |
| IRON WORKER | E | ALL | | 40.750 | 42.750 | 2.0 | 2.0 | 2.0 | 12.45 | 17.09 | 0.000 | 0.300 |
| IRON WORKER | W | ALL | | 43.300 | 45.460 | 2.0 | 2.0 | 2.0 | 8.140 | 17.29 | 0.000 | 0.400 |
| LABORER | | ALL | | 35.200 | 35.950 | 1.5 | 1.5 | 2.0 | 10.63 | 8.570 | 0.000 | 0.450 |
| LATHER | | ALL | | 40.770 | 42.770 | 1.5 | 1.5 | 2.0 | 9.840 | 9.790 | 0.000 | 0.490 |
| MACHINIST | | BLD | | 43.160 | 45.160 | 1.5 | 1.5 | 2.0 | 7.640 | 8.700 | 0.000 | 0.000 |
| MARBLE FINISHERS | | ALL | | 29.100 | 0.000 | 1.5 | 1.5 | 2.0 | 8.800 | 10.67 | 0.000 | 0.740 |
| MARBLE MASON | | BLD | | 39.030 | 42.930 | 1.5 | 1.5 | 2.0 | 8.800 | 10.67 | 0.000 | 0.740 |
| MATERIAL TESTER I | | ALL | | 25.200 | 0.000 | 1.5 | 1.5 | 2.0 | 10.63 | 8.570 | 0.000 | 0.450 |
| MATERIALS TESTER II | | ALL | | 30.200 | 0.000 | 1.5 | 1.5 | 2.0 | 10.63 | 8.570 | 0.000 | 0.450 |
| MILLWRIGHT | | ALL | | 40.770 | 42.770 | 1.5 | 1.5 | 2.0 | 9.840 | 9.790 | 0.000 | 0.490 |
| OPERATING ENGINEER | | BLD | 1 | 45.100 | 49.100 | 2.0 | 2.0 | 2.0 | 11.70 | 8.050 | 1.900 | 1.150 |
| OPERATING ENGINEER | | BLD | 2 | 43.800 | 49.100 | 2.0 | 2.0 | 2.0 | 11.70 | 8.050 | 1.900 | 1.150 |
| OPERATING ENGINEER | | BLD | 3 | 41.250 | 49.100 | 2.0 | 2.0 | 2.0 | 11.70 | 8.050 | 1.900 | 1.150 |
| OPERATING ENGINEER | | BLD | 4 | 39.500 | 49.100 | 2.0 | 2.0 | 2.0 | 11.70 | 8.050 | 1.900 | 1.150 |
| OPERATING ENGINEER | | BLD | 5 | 48.850 | 49.100 | 2.0 | 2.0 | 2.0 | 11.70 | 8.050 | 1.900 | 1.150 |
| OPERATING ENGINEER | | BLD | 6 | 46.100 | 49.100 | 2.0 | 2.0 | 2.0 | 11.70 | 8.050 | 1.900 | 1.150 |
| OPERATING ENGINEER | | BLD | 7 | 48.100 | 49.100 | 2.0 | 2.0 | 2.0 | 11.70 | 8.050 | 1.900 | 1.150 |
| OPERATING ENGINEER | | HWY | 1 | 43.300 | 47.300 | 1.5 | 1.5 | 2.0 | 11.70 | 8.050 | 1.900 | 1.150 |
| OPERATING ENGINEER | | HWY | 2 | 42.750 | 47.300 | 1.5 | 1.5 | 2.0 | 11.70 | 8.050 | 1.900 | 1.150 |
| OPERATING ENGINEER | | HWY | 3 | 40.700 | 47.300 | 1.5 | 1.5 | 2.0 | 11.70 | 8.050 | 1.900 | 1.150 |
| OPERATING ENGINEER | | HWY | 4 | 39.300 | 47.300 | 1.5 | 1.5 | 2.0 | 11.70 | 8.050 | 1.900 | 1.150 |
| OPERATING ENGINEER | | HWY | 5 | 38.100 | 47.300 | 1.5 | 1.5 | 2.0 | 11.70 | 8.050 | 1.900 | 1.150 |
| OPERATING ENGINEER | | HWY | 6 | 46.300 | 47.300 | 1.5 | 1.5 | 2.0 | 11.70 | 8.050 | 1.900 | 1.150 |
| OPERATING ENGINEER | | HWY | 7 | 44.300 | 47.300 | 1.5 | 1.5 | 2.0 | 11.70 | 8.050 | 1.900 | 1.150 |
| ORNAMNTL IRON WORKER E | E | ALL | | 40.200 | 42.450 | 2.0 | 2.0 | 2.0 | 10.67 | 14.81 | 0.000 | 0.500 |
| ORNAMNTL IRON WORKER W | W | ALL | | 43.300 | 45.460 | 2.0 | 2.0 | 2.0 | 8.140 | 17.29 | 0.000 | 0.400 |
| PAINTER | | ALL | | 40.180 | 42.180 | 1.5 | 1.5 | 1.5 | 8.950 | 8.200 | 0.000 | 1.250 |
| PAINTER SIGNS | | BLD | | 32.770 | 36.800 | 1.5 | 1.5 | 1.5 | 2.600 | 2.620 | 0.000 | 0.000 |
| PILEDRIIVER | | ALL | | 40.770 | 42.770 | 1.5 | 1.5 | 2.0 | 9.840 | 9.790 | 0.000 | 0.490 |
| PIPEFITTER | | BLD | | 40.250 | 42.250 | 1.5 | 1.5 | 2.0 | 10.15 | 13.49 | 0.000 | 1.360 |
| PLASTERER | | BLD | | 39.360 | 41.720 | 1.5 | 1.5 | 2.0 | 8.800 | 12.12 | 0.000 | 0.510 |
| PLUMBER | | BLD | | 40.250 | 42.250 | 1.5 | 1.5 | 2.0 | 10.15 | 13.49 | 0.000 | 1.360 |
| ROOFER | | BLD | | 37.650 | 40.650 | 1.5 | 1.5 | 2.0 | 7.750 | 6.570 | 0.000 | 0.430 |
| SHEETMETAL WORKER | | BLD | | 41.660 | 43.660 | 1.5 | 1.5 | 2.0 | 8.810 | 10.66 | 0.000 | 0.780 |
| SPRINKLER FITTER | | BLD | | 49.200 | 51.200 | 1.5 | 1.5 | 2.0 | 8.500 | 8.050 | 0.000 | 0.450 |
| STEEL ERECTOR | E | ALL | | 40.750 | 42.750 | 2.0 | 2.0 | 2.0 | 10.95 | 15.99 | 0.000 | 0.300 |

| | | | | | | | | | | | |
|---------------------|---|-------|--------|--------|-----|-----|-----|-------|-------|-------|-------|
| STEEL ERECTOR | W | ALL | 43.300 | 45.460 | 2.0 | 2.0 | 2.0 | 8.140 | 17.29 | 0.000 | 0.400 |
| STONE MASON | | BLD | 39.030 | 42.930 | 1.5 | 1.5 | 2.0 | 8.800 | 10.67 | 0.000 | 0.740 |
| TERRAZZO FINISHER | | BLD | 35.150 | 0.000 | 1.5 | 1.5 | 2.0 | 6.950 | 10.57 | 0.000 | 0.430 |
| TERRAZZO MASON | | BLD | 39.010 | 42.010 | 1.5 | 1.5 | 2.0 | 6.950 | 11.91 | 0.000 | 0.510 |
| TILE MASON | | BLD | 40.490 | 44.490 | 2.0 | 1.5 | 2.0 | 6.950 | 9.730 | 0.000 | 0.610 |
| TRAFFIC SAFETY WRKR | | HWY | 28.250 | 29.850 | 1.5 | 1.5 | 2.0 | 4.896 | 4.175 | 0.000 | 0.000 |
| TRUCK DRIVER | | ALL 1 | 32.550 | 33.100 | 1.5 | 1.5 | 2.0 | 6.500 | 4.350 | 0.000 | 0.150 |
| TRUCK DRIVER | | ALL 2 | 32.700 | 33.100 | 1.5 | 1.5 | 2.0 | 6.500 | 4.350 | 0.000 | 0.150 |
| TRUCK DRIVER | | ALL 3 | 32.900 | 33.100 | 1.5 | 1.5 | 2.0 | 6.500 | 4.350 | 0.000 | 0.150 |
| TRUCK DRIVER | | ALL 4 | 33.100 | 33.100 | 1.5 | 1.5 | 2.0 | 6.500 | 4.350 | 0.000 | 0.150 |
| TUCKPOINTER | | BLD | 39.200 | 40.200 | 1.5 | 1.5 | 2.0 | 7.830 | 10.25 | 0.000 | 0.770 |

Legend:

M-F>8 (Overtime is required for any hour greater than 8 worked each day, Monday through Friday.)
 OSA (Overtime is required for every hour worked on Saturday)
 OSH (Overtime is required for every hour worked on Sunday and Holidays)
 H/W (Health & Welfare Insurance)
 Pensn (Pension)
 Vac (Vacation)
 Trng (Training)

Explanations**DUPAGE COUNTY**

IRON WORKERS AND FENCE ERECTOR (WEST) - West of Route 53.

The following list is considered as those days for which holiday rates of wages for work performed apply: New Years Day, Memorial Day, Fourth of July, Labor Day, Thanksgiving Day, Christmas Day and Veterans Day in some classifications/counties. Generally, any of these holidays which fall on a Sunday is celebrated on the following Monday. This then makes work performed on that Monday payable at the appropriate overtime rate for holiday pay. Common practice in a given local may alter certain days of celebration. If in doubt, please check with IDOL.

EXPLANATION OF CLASSES

ASBESTOS - GENERAL - removal of asbestos material/mold and hazardous materials from any place in a building, including mechanical systems where those mechanical systems are to be removed. This includes the removal of asbestos materials/mold and hazardous materials from ductwork or pipes in a building when the building is to be demolished at the time or at some close future date.

ASBESTOS - MECHANICAL - removal of asbestos material from mechanical systems, such as pipes, ducts, and boilers, where the mechanical systems are to remain.

TRAFFIC SAFETY - work associated with barricades, horses and drums used to reduce lane usage on highway work, the installation and removal of temporary lane markings, and the installation and removal of temporary road signs.

CERAMIC TILE FINISHER

The grouting, cleaning, and polishing of all classes of tile, whether for interior or exterior purposes, all burned, glazed or unglazed

products; all composition materials, granite tiles, warning detectable tiles, cement tiles, epoxy composite materials, pavers, glass, mosaics, fiberglass, and all substitute materials, for tile made in tile-like units; all mixtures in tile like form of cement, metals, and other materials that are for and intended for use as a finished floor surface, stair treads, promenade roofs, walks, walls, ceilings, swimming pools, and all other places where tile is to form a finished interior or exterior. The mixing of all setting mortars including but not limited to thin-set mortars, epoxies, wall mud, and any other sand and cement mixtures or adhesives when used in the preparation, installation, repair, or maintenance of tile and/or similar materials. The handling and unloading of all sand, cement, lime, tile, fixtures, equipment, adhesives, or any other materials to be used in the preparation, installation, repair, or maintenance of tile and/or similar materials. Ceramic Tile Finishers shall fill all joints and voids regardless of method on all tile work, particularly and especially after installation of said tile work. Application of any and all protective coverings to all types of tile installations including, but not be limited to, all soap compounds, paper products, tapes, and all polyethylene coverings, plywood, masonite, cardboard, and any new type of products that may be used to protect tile installations, Blastrac equipment, and all floor scarifying equipment used in preparing floors to receive tile. The clean up and removal of all waste and materials. All demolition of existing tile floors and walls to be re-tiled.

COMMUNICATIONS TECHNICIAN

Low voltage installation, maintenance and removal of telecommunication facilities (voice, sound, data and video) including telephone and data inside wire, interconnect, terminal equipment, central offices, PABX, fiber optic cable and equipment, micro waves, V-SAT, bypass, CATV, WAN (wide area networks), LAN (local area networks), and ISDN (integrated system digital network), pulling of wire in raceways, but not the installation of raceways.

MARBLE FINISHER

Loading and unloading trucks, distribution of all materials (all stone, sand, etc.), stocking of floors with material, performing all rigging for heavy work, the handling of all material that may be needed for the installation of such materials, building of scaffolding, polishing if needed, patching, waxing of material if damaged, pointing up, caulking, grouting and cleaning of marble, holding water on diamond or Carborundum blade or saw for setters cutting, use of tub saw or any other saw needed for preparation of material, drilling of holes for wires that anchor material set by setters, mixing up of molding plaster for installation of material, mixing up thin set for the installation of material, mixing up of sand to cement for the installation of material and such other work as may be required in helping a Marble Setter in the handling of all material in the erection or installation of interior marble, slate, travertine, art marble, serpentine, alberene stone, blue stone, granite and other stones (meaning as to stone any foreign or domestic materials as are specified and used in building interiors and exteriors and customarily known as stone in the trade), carrara, sanionyx, vitrolite and similar opaque glass and the laying of all marble tile, terrazzo tile, slate tile and precast tile, steps, risers treads, base, or any other materials that may be used as substitutes

for any of the aforementioned materials and which are used on interior and exterior which are installed in a similar manner.

MATERIAL TESTER I: Hand coring and drilling for testing of materials; field inspection of uncured concrete and asphalt.

MATERIAL TESTER II: Field inspection of welds, structural steel, fireproofing, masonry, soil, facade, reinforcing steel, formwork, cured concrete, and concrete and asphalt batch plants; adjusting proportions of bituminous mixtures.

OPERATING ENGINEER - BUILDING

Class 1. Asphalt Plant; Asphalt Spreader; Autograde; Backhoes with Caisson Attachment; Batch Plant; Benoto (requires Two Engineers); Boiler and Throttle Valve; Caisson Rigs; Central Redi-Mix Plant; Combination Back Hoe Front End-loader Machine; Compressor and Throttle Valve; Concrete Breaker (Truck Mounted); Concrete Conveyor; Concrete Conveyor (Truck Mounted); Concrete Paver Over 27E cu. ft; Concrete Paver 27E cu. ft. and Under; Concrete Placer; Concrete Placing Boom; Concrete Pump (Truck Mounted); Concrete Tower; Cranes, All; Cranes, Hammerhead; Cranes, (GCI and similar Type); Creter Crane; Crusher, Stone, etc.; Derricks, All; Derricks, Traveling; Formless Curb and Gutter Machine; Grader, Elevating; Grouting Machines; Highlift Shovels or Front Endloader 2-1/4 yd. and over; Hoists, Elevators, outside type rack and pinion and similar machines; Hoists, One, Two and Three Drum; Hoists, Two Tugger One Floor; Hydraulic Backhoes; Hydraulic Boom Trucks; Hydro Vac (and similar equipment); Locomotives, All; Motor Patrol; Lubrication Technician; Manipulators; Pile Drivers and Skid Rig; Post Hole Digger; Pre-Stress Machine; Pump Cretes Dual Ram; Pump Cretes: Squeeze Cretes-Screw Type Pumps; Gypsum Bulker and Pump; Raised and Blind Hole Drill; Roto Mill Grinder; Scoops - Tractor Drawn; Slip-Form Paver; Straddle Buggies; Tournapull; Tractor with Boom and Side Boom; Trenching Machines.

Class 2. Boilers; Broom, All Power Propelled; Bulldozers; Concrete Mixer (Two Bag and Over); Conveyor, Portable; Forklift Trucks; Highlift Shovels or Front Endloaders under 2-1/4 yd.; Hoists, Automatic; Hoists, Inside Elevators; Hoists, Sewer Dragging Machine; Hoists, Tugger Single Drum; Rock Drill (Self-Propelled); Rock Drill (Truck Mounted); Rollers, All; Steam Generators; Tractors, All; Tractor Drawn Vibratory Roller; Winch Trucks with "A" Frame.

Class 3. Air Compressor; Combination Small Equipment Operator; Generators; Heaters, Mechanical; Hoists, Inside Elevators; Hydraulic Power Units (Pile Driving, Extracting, and Drilling); Pumps, over 3" (1 to 3 not to exceed a total of 300 ft.); Low Boys; Pumps, Well Points; Welding Machines (2 through 5); Winches, 4 Small Electric Drill Winches; Bobcats (up to and including $\frac{3}{4}$ cu yd.) .

Class 4. Bobcats and/or other Skid Steer Loaders (other than bobcats up to and including $\frac{3}{4}$ cu yd.); Oilers; and Brick Forklift.

Class 5. Assistant Craft Foreman.

Class 6. Gradall.

Class 7. Mechanics.

OPERATING ENGINEERS - HIGHWAY CONSTRUCTION

Class 1. Asphalt Plant; Asphalt Heater and Planer Combination; Asphalt Heater Scarfire; Asphalt Spreader; Autograder/GOMACO or other similar type machines: ABG Paver; Backhoes with Caisson Attachment; Ballast Regulator; Belt Loader; Caisson Rigs; Car Dumper; Central Redi-Mix Plant; Combination Backhoe Front Endloader Machine, (1 cu. yd. Backhoe Bucket or over or with attachments); Concrete Breaker (Truck Mounted); Concrete Conveyor; Concrete Paver over 27E cu. ft.; Concrete Placer; Concrete Tube Float; Cranes, all attachments; Cranes, Tower Cranes of all types: Creter Crane: Crusher, Stone, etc.; Derricks, All; Derrick Boats; Derricks, Traveling; Dowell Machine with Air Compressor; Dredges; Formless Curb and Gutter Machine; Grader, Elevating; Grader, Motor Grader, Motor Patrol, Auto Patrol, Form Grader, Pull Grader, Subgrader; Guard Rail Post Driver Truck Mounted; Hoists, One, Two and Three Drum; Hydraulic Backhoes; Backhoes with shear attachments; Lubrication Technician; Manipulators; Mucking Machine; Pile Drivers and Skid Rig; Pre-Stress Machine; Pump Cretes Dual Ram; Rock Drill - Crawler or Skid Rig; Rock Drill - Truck Mounted; Rock/Track Tamper; Roto Mill Grinder; Slip-Form Paver; Soil Test Drill Rig (Truck Mounted); Straddle Buggies; Hydraulic Telescoping Form (Tunnel); Tractor Drawn Belt Loader (with attached pusher - two engineers); Tractor with Boom; Tractaire with Attachments; Trenching Machine; Truck Mounted Concrete Pump with Boom; Raised or Blind Hole Drills (Tunnel Shaft); Underground Boring and/or Mining Machines 5 ft. in diameter and over tunnel, etc; Underground Boring and/or Mining Machines under 5 ft. in diameter; Wheel Excavator; Widener (APSCO).

Class 2. Batch Plant; Bituminous Mixer; Boiler and Throttle Valve; Bulldozers; Car Loader Trailing Conveyors; Combination Backhoe Front Endloader Machine (Less than 1 cu. yd. Backhoe Bucket or over or with attachments); Compressor and Throttle Valve; Compressor, Common Receiver (3); Concrete Breaker or Hydro Hammer; Concrete Grinding Machine; Concrete Mixer or Paver 7S Series to and including 27 cu. ft.; Concrete Spreader; Concrete Curing Machine, Burlap Machine, Belting Machine and Sealing Machine; Concrete Wheel Saw; Conveyor Muck Cars (Haglund or Similar Type); Drills, All; Finishing Machine - Concrete; Highlift Shovels or Front Endloader; Hoist - Sewer Dragging Machine; Hydraulic Boom Trucks (All Attachments); Hydro-Blaster; All Locomotives, Dinky; Off-Road Hauling Units (including articulating)/2 ton capacity or more; Non Self-Loading Ejection Dump; Pump Cretes: Squeeze Cretes - Screw Type Pumps, Gypsum Bulker and Pump; Roller, Asphalt; Rotary Snow Plows; Rototiller, Seaman, etc., self-propelled; Scoops - Tractor Drawn; Self-Propelled Compactor; Spreader - Chip - Stone, etc.; Scraper; Scraper - Prime Mover in Tandem (Regardless of Size); Tank Car Heater; Tractors, Push, Pulling Sheeps Foot, Disc, Compactor, etc.; Tug Boats.

Class 3. Boilers; Brooms, All Power Propelled; Cement Supply Tender; Compressor, Common Receiver (2); Concrete Mixer (Two Bag and Over); Conveyor, Portable; Farm-Type Tractors Used for Mowing, Seeding, etc.; Fireman on Boilers; Forklift Trucks; Grouting Machine; Hoists, Automatic; Hoists, All Elevators; Hoists, Tugger Single Drum; Jeep Diggers; Low Boys; Pipe Jacking Machines; Post-Hole Digger; Power Saw, Concrete Power Driven; Pug Mills; Rollers, other than Asphalt; Seed and Straw Blower; Steam Generators; Stump Machine; Winch Trucks with "A" Frame; Work Boats; Tamper-Form-Motor Driven.

Class 4. Air Compressor; Combination - Small Equipment Operator; Directional Boring Machine; Generators; Heaters, Mechanical; Hydraulic Power Unit (Pile Driving, Extracting, or Drilling); Hydro- Blaster; Light Plants, All (1 through 5); Pumps, over 3" (1 to 3 not to exceed a total of 300 ft.); Pumps, Well Points; Tractaire; Welding Machines (2 through 5); Winches, 4 Small Electric Drill Winches.

Class 5. Bobcats (all); Brick Forklifts; Oilers.

Class 6. Field Mechanics and Field Welders

Class 7. Gradall and machines of like nature.

TRUCK DRIVER - BUILDING, HEAVY AND HIGHWAY CONSTRUCTION

Class 1. Two or three Axle Trucks. A-frame Truck when used for transportation purposes; Air Compressors and Welding Machines, including those pulled by cars, pick-up trucks and tractors; Ambulances; Batch Gate Lockers; Batch Hopperman; Car and Truck Washers; Carry-alls; Fork Lifts and Hoisters; Helpers; Mechanics Helpers and Greasers; Oil Distributors 2-man operation; Pavement Breakers; Pole Trailer, up to 40 feet; Power Mower Tractors; Self-propelled Chip Spreader; Skipman; Slurry Trucks, 2-man operation; Slurry Truck Conveyor Operation, 2 or 3 man; Teamsters Unskilled dumpman; and Truck Drivers hauling warning lights, barricades, and portable toilets on the job site.

Class 2. Four axle trucks; Dump Crets and Adgetors under 7 yards; Dumpsters, Track Trucks, Euclids, Hug Bottom Dump Turnapulls or Turnatrailers when pulling other than self-loading equipment or similar equipment under 16 cubic yards; Mixer Trucks under 7 yards; Ready-mix Plant Hopper Operator, and Winch Trucks, 2 Axles.

Class 3. Five axle trucks; Dump Crets and Adgetors 7 yards and over; Dumpsters, Track Trucks, Euclids, Hug Bottom Dump Turnatrailers or turnapulls when pulling other than self-loading equipment or similar equipment over 16 cubic yards; Explosives and/or Fission Material Trucks; Mixer Trucks 7 yards or over; Mobile Cranes while in transit; Oil Distributors, 1-man operation; Pole Trailer, over 40 feet; Pole and Expandable Trailers hauling material over 50 feet long; Slurry trucks, 1-man operation; Winch trucks, 3 axles or more; Mechanic--Truck Welder and Truck Painter.

Class 4. Six axle trucks; Dual-purpose vehicles, such as mounted crane trucks with hoist and accessories; Foreman; Master Mechanic; Self-loading equipment like P.B. and trucks with scoops on the front.

TERRAZZO FINISHER

The handling of sand, cement, marble chips, and all other materials that may be used by the Mosaic Terrazzo Mechanic, and the mixing, grinding, grouting, cleaning and sealing of all Marble, Mosaic, and Terrazzo work, floors, base, stairs, and wainscoting by hand or machine, and in addition, assisting and aiding Marble, Masonic, and Terrazzo Mechanics.

Other Classifications of Work:

For definitions of classifications not otherwise set out, the Department generally has on file such definitions which are available. If a task to be performed is not subject to one of the classifications of pay set out, the Department will upon being contacted state which neighboring county has such a classification and provide such rate, such rate being deemed to exist by reference in this document. If no neighboring county rate applies to the task, the Department shall undertake a special determination, such special determination being then deemed to have existed under this determination. If a project requires these, or any classification not listed, please contact IDOL at 217-782-1710 for wage rates or clarifications.

LANDSCAPING

Landscaping work falls under the existing classifications for laborer, operating engineer and truck driver. The work performed by landscape plantsman and landscape laborer is covered by the existing classification of laborer. The work performed by landscape operators (regardless of equipment used or its size) is covered by the classifications of operating engineer. The work performed by landscape truck drivers (regardless of size of truck driven) is covered by the classifications of truck driver.

AGENDA MEMO
Municipal Services Committee
April 25, 2011

Issue Statement

Consideration of a motion to extend a contract through the attached resolution with Gaffney's Protective Maintenance Inc. for the annual 2011/12 Street Light Maintenance Contract. The proposed contract extension would be the last extension of a three (3) year option.

Background/History

On March 10, 2009, Staff had received five sealed bids for the 2009 street light maintenance contract, with Gaffney's Protective Maintenance Inc. being the awarded vendor. The bid contained two additional one year option extensions for 2010/11 and 2011/12. This proposal would be the last option extension and the vendor, Gaffney's PMI has accepted the extension for the 2011/12 Street Light contract. Below, please find a summary of the items within the proposed contract.

Item 1-Cost to Repair Street Light- See page 4. This item requires the vendor to repair the street light at a specified unit cost. The repair would include items such as a light bulb, ballast, and fuse kit.

Item 2-Hourly Rate for Labor and Equipment- See page 5. This item required the vendor to provide unit costs on an hourly basis for labor and equipment. Such items would include a light pole knock down, identifying a ground fault or any other extraordinary mishaps.

Items 3, 4 and 5-Lamp Charges- See page 6. This item requires the vendor to provide unit pricing for various lamps to relamp a light pole(s) to a requested wattage. These items would be utilized if it was determined that an increased or reduced wattage light bulb would better serve an intersection or residence.

Option 6-Aluminum Pole- Option 7-Concrete Pole-Option 8-Uni Duct- See page 7. Occasionally the City of Darien receives petitioned requests for the installation of aluminum and concrete street lights. The light pole installation will be subject to an additional cost for uni-duct wiring, (**Option 8**) at a per a lineal foot unit price installed.

Option 9-Straightening of Concrete Poles-See page 7. Occasionally the City of Darien is required to straighten out concrete light poles. This work shall consist of removing the appropriate subgrade as to allow the light pole to be moved into a plumb position.

Option 10-Remove and Replace Lens Covers- See page 7. Occasionally the City of Darien is required to remove and replace a lens cover due to discoloring. This item includes the cover and labor to install.

Funding for the Street Light Services would be expended from the following line item of the FY 11/12 Budget:

| ACCOUNT NUMBER | ACCOUNT DESCRIPTION | FY 11/12 BUDGET | PROPOSED EXPENDITURE |
|----------------|--------------------------------------|-----------------|----------------------|
| 01-30-4359 | STREET LIGHT OPERATION & MAINTENANCE | \$ 18,000.00 | \$ 18,000.00 |
| 01-30-4359 | STREET LIGHT INSTALLATION | \$ 12,000.00 | \$ 12,000.00 |

Staff Recommendation

Staff recommends approval of the contract extension through the attached resolution. The vendor has provided excellent service to the City.

Alternate Consideration

Not approving the street light maintenance contract.

Decision Mode

This item will be placed on the May 2, 2011 City Council agenda for formal consideration.

Ashley Prueter

From: Dan Gombac
Sent: Thursday, April 07, 2011 10:25 AM
To: Ashley Prueter
Subject: FW: 2011 Street Light Contract

for agenda

Daniel Gombac
Director of Municipal Services
630-353-8106

From: Steve Spoerl, Gaffney's PMI [<mailto:S.Spoerl@GaffneysPMI.net>]
Sent: Thursday, April 07, 2011 10:13 AM
To: Dan Gombac
Subject: RE: 2011 Street Light Contract

Dan,

Gaffney's PMI will agree to the extension for the third year of our arrangement.

Steve Spoerl

From: Dan Gombac [<mailto:dgombac@darienil.gov>]
Sent: Wednesday, April 06, 2011 3:44 PM
To: S.Spoerl@GaffneysPMI.net
Cc: Ashley Prueter
Subject: 2011 Street Light Contract

Steve:

The City is requesting an extension of the 3rd year street light contract at the proposed 2011 unit costs. Please let me know if Gaffney's will entertain the extension. Pending Committee and City Council approval the contract becomes effective May 1, 2011 through April 30, 2012.

Please respond at your earliest convenience.

Thanks

Daniel Gombac
Director of Municipal Services
630-353-8106

COST TO REPAIR STREET LIGHT OUTAGE WITH ESTIMATED OUTAGES

| 2009 PRICING | | ITEM 1 | ITEM 1 | Ranking by Cost |
|---------------------|-----------------------------------|--------------------------|--------------------------|-----------------|
| Company Name | Unit Cost-Per Street Light Repair | 114 Street Light Repairs | 114 Street Light Repairs | Ranking by Cost |
| Gaffney's PMI | \$ 63.00 | \$ 7,182.00 | | 1 |
| RAGS Electric | \$ 180.00 | \$ 20,520.00 | | 3 |
| Meade Electric | \$ 185.00 | \$ 21,090.00 | | 4 |
| Lyons Electric | \$ 160.00 | \$ 18,240.00 | | 2 |
| H & H Electric | \$ 378.70 | \$ 43,171.80 | | 5 |
| 2010 PRICING | | ITEM 1 | ITEM 1 | Ranking by Cost |
| Company Name | Unit Cost-Per Street Light Repair | 114 Street Light Repairs | 114 Street Light Repairs | Ranking by Cost |
| Gaffney's PMI | \$ 64.00 | \$ 7,296.00 | | 1 |
| RAGS Electric | \$ 188.00 | \$ 21,432.00 | | 3 |
| Meade Electric | \$ 194.00 | \$ 22,116.00 | | 4 |
| Lyons Electric | \$ 165.00 | \$ 18,810.00 | | 2 |
| H & H Electric | \$ 393.90 | \$ 44,904.60 | | 5 |
| 2011 PRICING | | ITEM 1 | ITEM 1 | Ranking by Cost |
| Company Name | Unit Cost-Per Street Light Repair | 114 Street Light Repairs | 114 Street Light Repairs | Ranking by Cost |
| Gaffney's PMI | \$ 67.00 | \$ 7,638.00 | | 1 |
| RAGS Electric | \$ 195.00 | \$ 22,230.00 | | 3 |
| Meade Electric | \$ 204.00 | \$ 23,256.00 | | 4 |
| Lyons Electric | \$ 170.00 | \$ 19,380.00 | | 2 |
| H & H Electric | \$ 409.70 | \$ 46,705.80 | | 5 |

HOURLY RATES

2009 - HOURLY LABOR RATES

| Company Name | Journeyman Straight Time | Journeyman Over Time | Helper Straight Time | Helper Over Time | Bucket Truck | Lift Truck | Pickup Truck | Auger/Backhoe | ITEM 2-Hourly Labor Rates | Ranking |
|----------------|--------------------------|----------------------|----------------------|------------------|--------------|------------|--------------|---------------|---------------------------|---------|
| Gaffney's PMI | \$ 60.00 | \$ 80.00 | \$ 50.00 | \$ 80.00 | \$ 20.00 | \$ 20.00 | \$ 10.00 | \$ 5.00 | \$ 335.00 | 1 |
| RAGS Electric | \$ 85.00 | \$ 126.00 | \$ 69.00 | \$ 99.00 | \$ 39.50 | \$ 31.00 | \$ 11.00 | \$ 41.50 | \$ 502.00 | 4 |
| Meade Electric | \$ 95.00 | \$ 140.00 | \$ 68.00 | \$ 100.00 | \$ 43.00 | \$ 37.00 | \$ 19.00 | \$ 47.00 | \$ 549.00 | 5 |
| Lyons Electric | \$ 85.00 | \$ 120.00 | \$ 65.00 | \$ 90.00 | \$ 40.00 | \$ 40.00 | \$ 15.00 | \$ 40.00 | \$ 485.00 | 3 |
| H & H Electric | \$ 79.90 | \$ 119.85 | \$ 62.70 | \$ 94.10 | \$ 42.50 | \$ 42.50 | \$ 13.00 | \$ 39.10 | \$ 493.65 | 2 |

2010 - HOURLY LABOR RATES

| Company Name | Journeyman Straight Time | Journeyman Over Time | Helper Straight Time | Helper Over Time | Bucket Truck | Lift Truck | Pickup Truck | Auger/Backhoe | ITEM 2-Hourly Labor Rates | Ranking |
|----------------|--------------------------|----------------------|----------------------|------------------|--------------|------------|--------------|---------------|---------------------------|---------|
| Gaffney's PMI | \$ 60.00 | \$ 90.00 | \$ 50.00 | \$ 80.00 | \$ 20.00 | \$ 20.00 | \$ 10.00 | \$ 5.00 | \$ 335.00 | 1 |
| RAGS Electric | \$ 82.66 | \$ 119.60 | \$ 72.28 | \$ 109.20 | \$ 36.40 | \$ 36.40 | \$ 14.56 | \$ 52.00 | \$ 523.12 | 4 |
| Meade Electric | \$ 98.50 | \$ 145.00 | \$ 70.75 | \$ 104.00 | \$ 44.00 | \$ 38.00 | \$ 19.50 | \$ 48.50 | \$ 568.25 | 5 |
| Lyons Electric | \$ 87.00 | \$ 122.00 | \$ 65.00 | \$ 90.00 | \$ 40.00 | \$ 40.00 | \$ 15.00 | \$ 40.00 | \$ 499.00 | 2 |
| H & H Electric | \$ 83.10 | \$ 124.70 | \$ 65.30 | \$ 97.90 | \$ 44.20 | \$ 44.20 | \$ 13.60 | \$ 40.70 | \$ 513.70 | 3 |

2011 - HOURLY LABOR RATES

| Company Name | Journeyman Straight Time | Journeyman Over Time | Helper Straight Time | Helper Over Time | Bucket Truck | Lift Truck | Pickup Truck | Auger/Backhoe | ITEM 2-Hourly Labor Rates | Ranking |
|----------------|--------------------------|----------------------|----------------------|------------------|--------------|------------|--------------|---------------|---------------------------|---------|
| Gaffney's PMI | \$ 63.00 | \$ 95.00 | \$ 53.00 | \$ 85.00 | \$ 22.00 | \$ 22.00 | \$ 12.00 | \$ 7.00 | \$ 359.00 | 1 |
| RAGS Electric | \$ 86.00 | \$ 132.00 | \$ 72.00 | \$ 103.00 | \$ 41.00 | \$ 32.00 | \$ 12.00 | \$ 42.75 | \$ 522.75 | 2 |
| Meade Electric | \$ 102.00 | \$ 150.00 | \$ 73.50 | \$ 108.00 | \$ 45.00 | \$ 39.00 | \$ 20.00 | \$ 50.00 | \$ 587.50 | 5 |
| Lyons Electric | \$ 90.00 | \$ 125.00 | \$ 70.00 | \$ 100.00 | \$ 45.00 | \$ 45.00 | \$ 18.00 | \$ 45.00 | \$ 538.00 | 4 |
| H & H Electric | \$ 86.50 | \$ 129.70 | \$ 66.00 | \$ 101.90 | \$ 46.00 | \$ 46.00 | \$ 14.20 | \$ 42.40 | \$ 534.70 | 3 |

LAMP TALLY

| 2009 PRICING | ITEM 3 | | | | | | ITEM 4 | | | ITEM 5 | | | TOTAL ITEMS 3,4,5 | | |
|----------------------|----------------------|----------|----------|----------|----------|---------------|---------------|----------|----------------|----------------|----------|-------------------|-------------------|-----------------|------|
| | High Pressure Sodium | | | | | | Mercury Vapor | | | Mercury Halide | | | Total Lamp Charge | Ranking by Cost | |
| | 100W | 150W | 200W | 250W | 100W | 175W | 250W | 100W | 175W | 250W | 100W | 175W | | | 250W |
| Gaffney's PMI | \$ 9.50 | \$ 10.50 | \$ 9.50 | \$ 9.50 | \$ 19.00 | \$ 22.50 | \$ 11.00 | \$ 19.00 | \$ 14.00 | \$ 14.00 | \$ 19.00 | \$ 14.00 | \$ 14.00 | \$ 138.50 | 1 |
| RAGS Electric | \$ 15.60 | \$ 15.60 | \$ 15.60 | \$ 15.60 | \$ 15.60 | \$ 15.60 | \$ 15.60 | \$ 22.88 | \$ 15.60 | \$ 15.60 | \$ 22.88 | \$ 15.60 | \$ 15.60 | \$ 163.28 | 3 |
| Meade Electric | \$ 13.00 | \$ 13.00 | \$ 13.00 | \$ 13.00 | \$ 10.00 | \$ 10.00 | \$ 10.00 | \$ 23.00 | \$ 23.00 | \$ 23.00 | \$ 23.00 | \$ 23.00 | \$ 23.00 | \$ 151.00 | 2 |
| Lyons Electric | \$ 15.00 | \$ 15.00 | \$ 15.00 | \$ 15.00 | \$ 25.00 | \$ 15.00 | \$ 15.00 | \$ 25.00 | \$ 25.00 | \$ 25.00 | \$ 25.00 | \$ 25.00 | \$ 25.00 | \$ 190.00 | 4 |
| H & H Electric | \$ 16.50 | \$ 17.30 | \$ 17.60 | \$ 17.60 | \$ 36.20 | \$ 13.80 | \$ 20.10 | \$ 33.60 | \$ 21.00 | \$ 21.00 | \$ 33.60 | \$ 21.00 | \$ 21.00 | \$ 214.70 | 5 |
| 2010 PRICING | ITEM 3 | | | | | | ITEM 4 | | | ITEM 5 | | | TOTAL ITEMS 3,4,5 | | |
| High Pressure Sodium | | | | | | Mercury Vapor | | | Mercury Halide | | | Total Lamp Charge | Ranking by Cost | | |
| Company Name | 100W | 150W | 200W | 250W | 100W | 175W | 250W | 100W | 175W | 250W | 100W | | | 175W | 250W |
| Gaffney's PMI | \$ 9.50 | \$ 10.50 | \$ 9.50 | \$ 9.50 | \$ 19.00 | \$ 22.50 | \$ 11.00 | \$ 19.00 | \$ 14.00 | \$ 14.00 | \$ 19.00 | \$ 14.00 | \$ 14.00 | \$ 138.50 | 1 |
| RAGS Electric | \$ 14.50 | \$ 15.50 | \$ 9.00 | \$ 15.50 | \$ 10.50 | \$ 11.90 | \$ 11.90 | \$ 23.95 | \$ 22.50 | \$ 22.50 | \$ 23.95 | \$ 22.50 | \$ 22.50 | \$ 157.75 | 3 |
| Meade Electric | \$ 13.00 | \$ 13.00 | \$ 13.00 | \$ 13.00 | \$ 10.00 | \$ 10.00 | \$ 10.00 | \$ 23.00 | \$ 23.00 | \$ 23.00 | \$ 23.00 | \$ 23.00 | \$ 23.00 | \$ 151.00 | 2 |
| Lyons Electric | \$ 15.00 | \$ 15.00 | \$ 15.00 | \$ 15.00 | \$ 25.00 | \$ 15.00 | \$ 15.00 | \$ 25.00 | \$ 25.00 | \$ 25.00 | \$ 25.00 | \$ 25.00 | \$ 25.00 | \$ 190.00 | 4 |
| H & H Electric | \$ 17.20 | \$ 18.00 | \$ 18.40 | \$ 18.40 | \$ 37.70 | \$ 14.40 | \$ 21.00 | \$ 35.00 | \$ 21.90 | \$ 21.90 | \$ 35.00 | \$ 21.90 | \$ 21.90 | \$ 223.90 | 5 |
| 2011 PRICING | ITEM 3 | | | | | | ITEM 4 | | | ITEM 5 | | | TOTAL ITEMS 3,4,5 | | |
| High Pressure Sodium | | | | | | Mercury Vapor | | | Mercury Halide | | | Total Lamp Charge | Ranking by Cost | | |
| Company Name | 100W | 150W | 200W | 250W | 100W | 175W | 250W | 100W | 175W | 250W | 100W | | | 175W | 250W |
| Gaffney's PMI | \$ 10.00 | \$ 11.00 | \$ 10.00 | \$ 10.00 | \$ 20.00 | \$ 24.00 | \$ 12.00 | \$ 20.00 | \$ 15.00 | \$ 15.00 | \$ 20.00 | \$ 15.00 | \$ 15.00 | \$ 147.00 | 1 |
| RAGS Electric | \$ 15.50 | \$ 16.50 | \$ 9.00 | \$ 16.50 | \$ 10.50 | \$ 11.90 | \$ 11.90 | \$ 25.65 | \$ 24.10 | \$ 24.10 | \$ 25.65 | \$ 24.10 | \$ 24.10 | \$ 165.85 | 3 |
| Meade Electric | \$ 13.00 | \$ 13.00 | \$ 13.00 | \$ 13.00 | \$ 10.00 | \$ 10.00 | \$ 10.00 | \$ 23.00 | \$ 23.00 | \$ 23.00 | \$ 23.00 | \$ 23.00 | \$ 23.00 | \$ 151.00 | 2 |
| Lyons Electric | \$ 18.00 | \$ 18.00 | \$ 18.00 | \$ 18.00 | \$ 30.00 | \$ 18.00 | \$ 18.00 | \$ 30.00 | \$ 30.00 | \$ 30.00 | \$ 30.00 | \$ 30.00 | \$ 30.00 | \$ 228.00 | 4 |
| H & H Electric | \$ 17.90 | \$ 18.80 | \$ 19.20 | \$ 19.20 | \$ 39.30 | \$ 15.00 | \$ 21.90 | \$ 36.40 | \$ 22.80 | \$ 22.80 | \$ 36.40 | \$ 22.80 | \$ 22.80 | \$ 233.30 | 5 |

X

2009 - OPTION SUMMARY

| Company Name | Option 6 Aluminum Pole Quantity 4 | Option 6 Aluminum Pole Quantity 4 | Option 7 Concrete Pole Quantity 4 | Option 8 Cost for Unduct Quantity 400 Feet | Option 9 Straightening of Concrete Poles Quantity 50 | Option 9 Straightening of Concrete Poles Quantity 50 | Option 10 Clean and Inventory No Quantity | Option 10 Remove and Replace Lens Based on Budget Estimate of \$14,500 | Option 11 Remove and Replace Lens Based on Budget Estimate of \$14,500 | Ranking | |
|----------------|---|---|---|---|---|---|--|---|---|--------------|---|
| Gaffney's PMI | \$ 2,350.00 | \$ 9,280.00 | \$ 2,295.00 | \$ 7.50 | \$ 3,000.00 | \$ 24,000.00 | \$ 18,664.80 | \$ 43,750.00 | \$ 83 | \$ 45,974.00 | 2 |
| RAGS Electric | \$ 2,600.00 | \$ 11,200.00 | \$ 2,350.00 | \$ 10.40 | \$ 4,160.00 | \$ 22,500.00 | \$ 11,088.00 | \$ 62,500.00 | \$ 97 | \$ 47,774.00 | 3 |
| Meade Electric | \$ 2,500.00 | \$ 10,000.00 | \$ 2,500.00 | \$ 15.00 | \$ 6,000.00 | \$ 25,000.00 | \$ 15,400.00 | \$ 37,500.00 | \$ 58 | \$ 51,514.00 | 4 |
| Lyons Electric | \$ 2,600.00 | \$ 10,400.00 | \$ 2,600.00 | \$ 10.00 | \$ 4,000.00 | \$ 12,500.00 | \$ 15,400.00 | \$ 50,250.00 | \$ 64 | \$ 37,814.00 | 1 |
| H & H Electric | \$ 3,248.90 | \$ 12,995.60 | \$ 3,344.00 | \$ 2.90 | \$ 1,160.00 | \$ 39,020.00 | \$ 13,552.00 | \$ 44,125.00 | \$ 82 | \$ 67,665.60 | 5 |

2010 - OPTION SUMMARY

| Company Name | Option 6 Aluminum Pole Quantity 4 | Option 6 Aluminum Pole Quantity 4 | Option 7 Concrete Pole Quantity 4 | Option 8 Cost for Unduct Quantity 400 Feet | Option 9 Straightening of Concrete Poles Quantity 50 | Option 9 Straightening of Concrete Poles Quantity 50 | Option 10 Clean and Inventory No Quantity | Option 11 Remove and Replace Lens Based on Budget Estimate of \$14,500 | Option 11 Remove and Replace Lens Based on Budget Estimate of \$14,500 | Ranking | |
|----------------|---|---|---|---|---|---|--|---|---|--------------|---|
| Gaffney's PMI | \$ 2,320.00 | \$ 9,280.00 | \$ 2,295.00 | \$ 7.50 | \$ 3,000.00 | \$ 24,000.00 | \$ - | \$ 45,000.00 | \$ 32 | \$ 45,974.00 | 2 |
| RAGS Electric | \$ 2,840.00 | \$ 11,760.00 | \$ 2,450.00 | \$ 10.75 | \$ 4,300.00 | \$ 23,750.00 | \$ - | \$ 67,500.00 | \$ 21 | \$ 50,124.00 | 3 |
| Meade Electric | \$ 2,650.00 | \$ 10,600.00 | \$ 2,650.00 | \$ 16.00 | \$ 6,400.00 | \$ 26,700.00 | \$ - | \$ 43,750.00 | \$ 33 | \$ 54,814.00 | 4 |
| Lyons Electric | \$ 2,700.00 | \$ 10,800.00 | \$ 2,700.00 | \$ 10.00 | \$ 4,000.00 | \$ 12,500.00 | \$ - | \$ 55,250.00 | \$ 26 | \$ 38,614.00 | 1 |
| H & H Electric | \$ 3,378.90 | \$ 13,515.60 | \$ 3,477.80 | \$ 3.10 | \$ 1,240.00 | \$ 41,205.00 | \$ - | \$ 45,900.00 | \$ 32 | \$ 70,385.80 | 5 |

2011 - OPTION SUMMARY

| Company Name | Option 6 Aluminum Pole Quantity 4 | Option 6 Aluminum Pole Quantity 4 | Option 7 Concrete Pole Quantity 4 | Option 8 Cost for Unduct Quantity 400 Feet | Option 9 Straightening of Concrete Poles Quantity 50 | Option 9 Straightening of Concrete Poles Quantity 50 | Option 10 Clean and Inventory No Quantity | Option 11 Remove and Replace Lens Based on Budget Estimate of \$14,500 | Option 11 Remove and Replace Lens Based on Budget Estimate of \$14,500 | Ranking | |
|----------------|---|---|---|---|---|---|--|---|---|--------------|---|
| Gaffney's PMI | \$ 2,435.00 | \$ 9,744.00 | \$ 2,410.00 | \$ 7.75 | \$ 3,100.00 | \$ 25,500.00 | \$ - | \$ 19,000.00 | \$ 81 | \$ 48,498.00 | 2 |
| RAGS Electric | \$ 3,085.00 | \$ 12,340.00 | \$ 2,575.00 | \$ 11.10 | \$ 4,440.00 | \$ 25,000.00 | \$ - | \$ 30,100.00 | \$ 48 | \$ 52,594.00 | 3 |
| Meade Electric | \$ 2,800.00 | \$ 11,200.00 | \$ 2,800.00 | \$ 17.00 | \$ 6,800.00 | \$ 28,000.00 | \$ - | \$ 16,300.00 | \$ 79 | \$ 57,714.00 | 4 |
| Lyons Electric | \$ 2,800.00 | \$ 11,200.00 | \$ 2,800.00 | \$ 13.00 | \$ 5,200.00 | \$ 14,250.00 | \$ - | \$ 25,000.00 | \$ 58 | \$ 42,364.00 | 1 |
| H & H Electric | \$ 3,514.10 | \$ 14,056.40 | \$ 3,517.00 | \$ 3.30 | \$ 1,320.00 | \$ 42,855.00 | \$ - | \$ 19,100.00 | \$ 76 | \$ 73,213.40 | 5 |

RESOLUTION NO. _____

A RESOLUTION AUTHORIZING THE MAYOR TO EXECUTE A CONTRACT EXTENSION FOR STREET LIGHT MAINTENANCE SERVICES BETWEEN THE CITY OF DARIEN AND GAFFNEY'S PROTECTIVE MAINTENANCE INC

BE IT RESOLVED BY THE CITY COUNCIL OF THE CITY OF DARIEN, DU PAGE COUNTY, ILLINOIS, as follows:

SECTION 1: The City Council of the City of Darien hereby authorizes the Mayor to execute a certain Contract Extension for the Maintenance Services to repair street lights as required within the City Limits between the City of Darien and Gaffney's Protective Maintenance Inc. The Contract further identifies a pricing schedule referred to as "Schedule of Prices" for various street light repairs and options. The extended contract would be effective from May 1, 2011 through April 30, 2012 at which time a final extension may be granted pending the Municipal Services Committee and City Council consideration.

SECTION 2: This Resolution shall be in full force and effect from and after its passage and approval as provided by law.

PASSED BY THE CITY COUNCIL OF THE CITY OF DARIEN, DU PAGE COUNTY, ILLINOIS, this 2nd day of May 2011.

AYES: _____

NAYS: _____

ABSENT: _____

APPROVED BY THE MAYOR OF THE CITY OF DARIEN, DU PAGE COUNTY, ILLINOIS, this 2nd day of May 2011.

KATHLEEN MOESLE WEAVER

RESOLUTION NO. _____

ATTEST:

JOANNE F. COLEMAN, CITY CLERK

APPROVED AS TO FORM:

CITY ATTORNEY

Gaffney's Protective Maint. Inc.

Name of Bidder:

Address:

1890 Suncoast Ln

Bataavia IL 60510

Telephone No.

630 761 5000

E-mail:

j.gaffney@gaffneyspmc.net

Signature:



Title:

President

Date:

3-11-09

Schedule of Prices

RETURN WITH PROPOSAL

(For complete information covering these items, see specifications)

| Item No. | Items | Unit | Quantity | Unit Price | Total |
|---------------------|---|------|----------|------------|------------------|
| 2011 PRICING | | | | | |
| 1 | Total cost to repair Street Light Outage | Ea. | Per Unit | 67.00 | 67.00 |
| 2 | Hourly Labor Rates | | | | |
| | Journeyman - Straight Time | Ea. | 1 | 63.00 | 63.00 |
| | Journeyman - Over Time | Ea. | 1 | 95.00 | 95.00 |
| | Helper - Straight Time | Ea. | 1 | 53.00 | 53.00 |
| | Helper - Over Time | Ea. | 1 | 85.00 | 85.00 |
| | Bucket Truck | Ea. | 1 | 22.00 | 22.00 |
| | Lift Truck | Ea. | 1 | 22.00 | 22.00 |
| | Pickup Truck | Ea. | 1 | 12.00 | 12.00 |
| | Auger/Backhoe | Ea. | 1 | 7.00 | 7.00 |
| 3 | Material Costs - High Pressure Sodium: | | | | |
| | 100 Watt | Ea. | 1 | 10.00 | 10.00 |
| | 150 Watt | Ea. | 1 | 11.00 | 11.00 |
| | 200 Watt | Ea. | 1 | 10.00 | 10.00 |
| | 250 Watt | Ea. | 1 | 10.00 | 10.00 |
| 4 | Material Costs - Mercury Vapor: | | | | |
| | 100 Watt | Ea. | 1 | 20.00 | 20.00 |
| | 175 Watt | Ea. | 1 | 24.00 | 24.00 |
| | 250 Watt | Ea. | 1 | 12.00 | 12.00 |
| 5 | Material Costs - Mercury Halide: | | | | |
| | 100 Watt | Ea. | 1 | 20.00 | 20.00 |
| | 175 Watt | Ea. | 1 | 15.00 | 15.00 |
| | 250 Watt | Ea. | 1 | 15.00 | 15.00 |
| 6-option | Purchase and Installation of Street Light | Ea. | 1 | 2436.00 | 2436.00 |
| | Aluminum pole 25' height with 8' arm - see attached for foundation detail and installation specifications | | | | |
| 7-option | Purchase and Installation of Street Light | Ea. | 1 | 2410.00 | 2410.00 |
| | Concrete pole 25' height with 8' arm - see attached for foundation detail and installation specifications | | | | |
| 8-option | Unit cost for Uniduct per foot - | Fl | 1 | 7.75 | 7.75 |
| | 1 1/4" - XLP-USP with 3 #6 Copper Wires | | | | |
| 9-option | Straightening of Concrete Light Poles | Ea. | 1 | 510.00 | 510.00 |
| 10-option | Remove and Replace Cobra Head Style Refractors | Ea. | 100 | 180.00 | 18,000.00 |
| | | | | | |
| | | | | | |
| Total | | | | | 23,936.75 |

NOTE TO ALL CONTRACTORS: The bid tabulations will be based upon Total Cost of items 1, 2, 3, 4, 5, 6, 7, 8, 9 and 10.

Bid Summary Sheet

Company Name: Gaffney's Protective Maintenance, Inc.

| | 2010 | 2011 |
|--|------------------|------------------|
| 1. Street Light Repair | 64.00 | 67.00 |
| 2. Hourly Labor Rates | 335.00 | 359.00 |
| 3. Material Costs – High Pressure Sodium | | |
| 100 Watt | 9.50 | 10.00 |
| 150 Watt | 10.50 | 11.00 |
| 200 Watt | 9.50 | 10.00 |
| 250 Watt | 9.50 | 10.00 |
| 4. Material Costs – Mercury Vapor | | |
| 100 Watt | 19.00 | 20.00 |
| 175 Watt | 22.50 | 24.00 |
| 250 Watt | 11.00 | 12.00 |
| 5. Material Costs – Mercury Halide | | |
| 100 Watt | 19.00 | 20.00 |
| 175 Watt | 14.00 | 15.00 |
| 250 Watt | 14.00 | 15.00 |
| 6. Purchase & Installation of Street Light – Aluminum Pole | 2320.00 | 2436.00 |
| 7. Purchase & Installation of Street Light – Concrete Pole | 2295.00 | 2410.00 |
| 8. Unit Cost for Uniduct per foot | 7.50 | 7.75 |
| 9. Straightening of Concrete Light Poles | 480.00 | 510.00 |
| 10. Removal and Replace Cobra Head Style Refractor | 45,000.00 | 18,000.00 |
| Total | 50,640.00 | 23,936.75 |

Licensed Electrical
Contractor:

Gaffney's PM1

Name

09-00000507 (City of Aurora)

Number

Expires 3/03/10

Address:

1890 Suncast Ln.

Batavia, IL 60510

Phone:

630-761-5000

Date:

3/10/09

Signature:

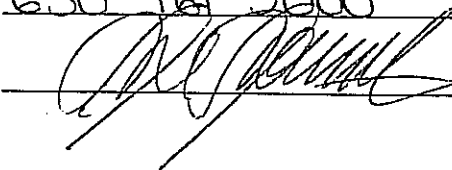

Subscribed and sworn before me on this 10 day of March, 2009

MY COMMISSION EXPIRES:

11-15-12

Mary L. Ryan

NOTARY PUBLIC

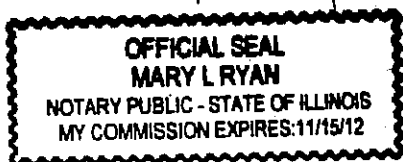

AGENDA MEMO
Municipal Services Committee
April 25, 2011

ISSUE STATEMENT

A resolution authorizing the Mayor and City Clerk to execute a contract with Tru Green for five (5) various fertilizer applications in an amount not to exceed \$18,010.00, for the 2011 Landscape Fertilization Services at Roadside Rights of Way and Medians of 75th Street, and a certain segments of Plainfield Road. Included also are City owned facilities such as the Water Plant grounds, the Public Works facility and the City Hall grounds.

BACKGROUND/HISTORY

On April 21, 2011 Staff received four bids for the proposed 2011 fertilization services. (See Attachment A). The fertilization program will allow the City to eradicate noxious weeds and provide uniform aesthetically pleasing turf throughout certain right of ways and City owned facilities.

The following areas would receive fertilizer applications throughout the year:

- 1) All median areas and roadside right of ways on 75th Street from Route 83 (Kingery Highway) east to Lemont Road-26.52 acres
- 2) Plainfield Road from Cass Avenue east to 75th Street- 2.00 acres

Total Acres 28.52 acres

City Owned Facilities:

| | <u>Acres</u> |
|------------------------------------|--------------|
| City Hall 1702 Plainfield Rd | 0.70 |
| Public Works 1041 S Frontage Rd | 1.70 |
| Water Plant #2 1220 Plainfield Rd | .33 |
| Water Plant #3 1930 Manning Rd | .57 |
| Water Plant #4 1901 Manning Rd | .66 |
| Water Plant #5 8600 Lemont Rd | .83 |
| Water Stand Pipe 6709 Wilmette Ave | <u>.11</u> |
| Total Acres | 4.90 |

The contract also entertained fertilization services for the City maintained median trees along 75th Street. The scope of work includes fertilizing 250 trees along 75th Street from Clarendon Hills Road east to Lemont Road.

The contract specifications included up to six (6) various fertilizer applications if required throughout the year. Staff is requesting that Applications 1, 2, 3, 4, and 5 for a total of five (5) applications be implemented for the 2011 Program. (See Attachment B).

The proposed expenditure would be expended from the following accounts.

| ACCOUNT NUMBER | ACCOUNT DESCRIPTION | FY 11/12 BUDGET | YEAR TO DATE EXPENDED | PROPOSED EXPENDITURE |
|---------------------------------------|--|------------------------|------------------------------|-----------------------------|
| 01-30-4350 | FORESTRY- FERTILIZATION 75 TH STREET-TURF AREAS | \$ 16,960.00 | \$ 0 | \$ 15,500.00 |
| 02-50-4223 | MAINTENANCE BUILDING-WATER PLANTS MAINTENANCE | \$ 3,000.00 | \$ 0 | \$ 2,151.43 |
| 01-10-4227 | MAINTENANCE BUILDING-CITY HALL GROUNDS | \$ 7,000.00 | \$ 0 | \$ 358.57 |
| TOTAL COST - FERTILIZATION | | | | \$ 18,010.00 |

STAFF RECOMMENDATION

Staff recommends awarding the competitive bid in an amount not to exceed \$18,010.00 for the City's 2011 Landscape Fertilization Services at Roadside Rights of Way and Medians and Specified City owned facilities to Tru Green.

Please note the contract entertains an additional one year contract extension for FY12/13. Staff will forward a recommendation upon the evaluation of the 2011 program.

ALTERNATE DECISION

Not approving the contract at this time would be an alternate decision.

DECISION MODE

This item will be placed on the May 2, 2011 City Council agenda for formal consideration.

**CITY OF DARIEN PUBLIC WORKS
1702 PLAINFIELD ROAD
DARIEN, IL 60561**

SEALED BID: 2011 Landscape Fertilization Program

OPENING DATE/TIME: April 21, 2011 @ 9:30 a.m.

| ITEM | Spring Green Lawn Care | | Illin-Scapes | | Autumn Blaze Tree & Turf | | Tru Green | |
|---------------------|------------------------|--------------|--------------|--------------|--------------------------|--------------|--------------|--------------|
| | Bid Bond | | Bid Bond | | Certified Check | | Bid Bond | |
| | 2011-12 | 2012-13 | 2011-12 | 2012-13 | 2011-12 | 2012-13 | 2011-12 | 2012-13 |
| Section I | | | | | | | | |
| | \$ 3,195.00 | \$ 3,195.00 | \$ 3,138.00 | \$ 3,138.00 | \$ 3,137.00 | \$ 3,137.00 | \$ 2,900.00 | \$ 2,900.00 |
| | \$ 3,451.00 | \$ 3,451.00 | \$ 3,936.00 | \$ 3,936.00 | \$ 3,793.00 | \$ 3,793.00 | \$ 3,200.00 | \$ 3,200.00 |
| | \$ 5,732.00 | \$ 5,732.00 | \$ 5,704.00 | \$ 5,704.00 | \$ 5,561.00 | \$ 5,561.00 | \$ 4,000.00 | \$ 4,000.00 |
| | \$ 2,966.00 | \$ 2,966.00 | \$ 3,080.00 | \$ 3,080.00 | \$ 2,795.00 | \$ 2,795.00 | \$ 2,700.00 | \$ 2,700.00 |
| | \$ 2,966.00 | \$ 2,966.00 | \$ 3,080.00 | \$ 3,080.00 | \$ 3,850.00 | \$ 3,850.00 | \$ 2,700.00 | \$ 2,700.00 |
| | \$ 2,052.00 | \$ 2,052.00 | \$ 1,569.00 | \$ 1,569.00 | \$ 2,355.00 | \$ 2,355.00 | \$ 2,000.00 | \$ 2,000.00 |
| Subtotal Section I | \$ 20,362.00 | \$ 20,362.00 | \$ 20,507.00 | \$ 20,507.00 | \$ 21,491.00 | \$ 21,491.00 | \$ 17,500.00 | \$ 17,500.00 |
| Section II | | | | | | | | |
| | \$ 467.00 | \$ 467.00 | \$ 476.00 | \$ 476.00 | \$ 539.00 | \$ 539.00 | \$ 420.00 | \$ 420.00 |
| | \$ 593.00 | \$ 593.00 | \$ 676.00 | \$ 676.00 | \$ 652.00 | \$ 652.00 | \$ 510.00 | \$ 510.00 |
| | \$ 919.00 | \$ 919.00 | \$ 956.00 | \$ 956.00 | \$ 956.00 | \$ 956.00 | \$ 720.00 | \$ 720.00 |
| | \$ 510.00 | \$ 510.00 | \$ 550.00 | \$ 550.00 | \$ 480.00 | \$ 480.00 | \$ 430.00 | \$ 430.00 |
| | \$ 510.00 | \$ 510.00 | \$ 784.00 | \$ 784.00 | \$ 662.00 | \$ 662.00 | \$ 430.00 | \$ 430.00 |
| | \$ 300.00 | \$ 300.00 | \$ 270.00 | \$ 270.00 | \$ 456.00 | \$ 456.00 | \$ 290.00 | \$ 290.00 |
| | \$ 3,299.00 | \$ 3,299.00 | \$ 3,712.00 | \$ 3,712.00 | \$ 3,745.00 | \$ 3,745.00 | \$ 2,800.00 | \$ 2,800.00 |
| Subtotal Section II | | | | | | | | |
| Section III | | | | | | | | |
| | \$ 1,850.00 | \$ 1,850.00 | \$ 2,300.00 | \$ 2,300.00 | \$ 1,632.00 | \$ 1,632.00 | \$ 1,575.00 | \$ 1,575.00 |
| Grand Total | \$ 25,511.00 | \$ 25,511.00 | \$ 26,519.00 | \$ 26,519.00 | \$ 26,868.00 | \$ 26,868.00 | \$ 21,875.00 | \$ 21,875.00 |

2011 FERTILIZATION PROGRAM

BID TALLY FROM 2011 CONTRACT FOR 2011

| SECTION I | | AWARDED VENDOR | | PROPOSED APPLICATIONS 2011 | | 2011 BID TABULATION | | 2011 BID TABULATION | |
|--|---------------------|----------------|-----------|----------------------------|-----------|---------------------|-----------|---------------------|-----------|
| | | Tru Green | | Tru Green | | Illini-Scapes | | Autumn Blaze & Tree | |
| | | 2011 BID | | | | | | Spring Green | |
| RIGHT OF WAY MAINTENANCE FERTILIZATION-28.52 ACRES | | | | | | | | | |
| PROGRAM INCLUDES: 75TH STREET-NORTHERN, SOUTHERN RIGHT OF WAYS AND MEDIANS | | | | | | | | | |
| PLAINFIELD ROAD-CASS AVE AND 75TH STREET | | | | | | | | | |
| | VENDOR APPLICATION | | | | | | | | |
| | Appl #1 March-April | \$ | 2,900.00 | \$ | 2,900.00 | | 3,138.00 | | 3,137.00 |
| | Appl #2 April-May | \$ | 3,200.00 | \$ | 3,200.00 | | 3,936.00 | | 3,793.00 |
| | Appl #3 May-June | \$ | 4,000.00 | \$ | 4,000.00 | | 5,704.00 | | 5,561.00 |
| | Appl #4 July-August | \$ | 2,700.00 | \$ | 2,700.00 | | 3,080.00 | | 3,795.00 |
| | Appl #5 September | \$ | 2,700.00 | \$ | 2,700.00 | | 3,080.00 | | 3,850.00 |
| | Appl #6 Nov-Dec | \$ | 2,000.00 | \$ | - | | 1,509.00 | | 2,455.00 |
| | Subtotal Section I | \$ | 17,500.00 | \$ | 15,500.00 | \$ | 20,507.00 | \$ | 21,491.00 |
| | | | | | | | | | 17,500.00 |

| SECTION II | | AWARDED VENDOR-TRU GREEN | | PROPOSED APPLICATIONS 2011 | | 2011 BID TABULATION | | 2011 BID TABULATION | |
|----------------------------------|---------------------|--------------------------|----------|----------------------------|----------|---------------------|----------|---------------------|----------|
| | | 2011 BID | | Tru Green | | Illini-Scapes | | Autumn Blaze & Tree | |
| CITY OWNED FACILITIES-1.90 ACRES | | | | | | | | | |
| WATER PLANT GROUNDS | | | | | | | | | |
| PUBLIC WORK FACILITY | | | | | | | | | |
| CITY HALL GROUNDS | | | | | | | | | |
| | VENDOR APPLICATION | | | | | | | | |
| | Appl #1 March-April | \$ | 430.00 | \$ | 420.00 | | 476.00 | | 539.00 |
| | Appl #2 April-May | \$ | 510.00 | \$ | 510.00 | | 676.00 | | 652.00 |
| | Appl #3 May-June | \$ | 720.00 | \$ | 720.00 | | 956.00 | | 956.00 |
| | Appl #4 July-August | \$ | 430.00 | \$ | 430.00 | | 550.00 | | 480.00 |
| | Appl #5 September | \$ | 430.00 | \$ | 430.00 | | 784.00 | | 663.00 |
| | Appl #6 Nov-Dec | \$ | 290.00 | \$ | - | | 270.00 | | 455.00 |
| | Subtotal Section II | \$ | 2,800.00 | \$ | 2,510.00 | \$ | 3,712.00 | \$ | 3,745.00 |
| | | | | | | | | | 2,800.00 |

| SECTION III | | AWARDED VENDOR-TRU GREEN | | PROPOSED APPLICATIONS 2011 | | 2011 BID TABULATION | | 2011 BID TABULATION | |
|--|--------------------------------|--------------------------|-----------|----------------------------|-----------|---------------------|-----------|---------------------|-----------|
| | | 2011 BID | | Spring Green Lawn Care | | Illini-Scapes | | Autumn Blaze & Tree | |
| TREE FERTILIZATION 250 TREES 75TH STREET | | | | | | | | | |
| | VENDOR APPLICATION | | | | | | | | |
| | Tree Fertilization-75th St | \$ | 1,575.00 | \$ | - | \$ | 2,300.00 | \$ | 1,632.00 |
| | Subtotal Section III | \$ | 1,575.00 | \$ | - | \$ | 2,300.00 | \$ | 1,632.00 |
| | Total Cost Section I, II & III | \$ | 21,875.00 | \$ | 18,010.00 | \$ | 26,519.00 | \$ | 26,868.00 |
| | | | | | | | | | 21,875.00 |

PER ACRE CALCULATION FOR PROPOSED CITY OWNED FACILITIES 2011 PROGRAM

| ACCOUNT CHARGE | 02-50-4223 | 02-50-4223 | 01-10-4227 | CITY FACILITIES PROGRAM COST | |
|-----------------------------|-------------------|-----------------------|-------------------|------------------------------|----------|
| LOCATION | 5-PLANT LOCATIONS | PUBLIC WORKS FACILITY | CITY HALL GROUNDS | | |
| ACRES | 2.5 | 1.7 | 0.7 | | |
| COST PER ACRE APPLICATION 1 | \$ 214.29 | \$ 145.71 | \$ 60.00 | \$ | 420.00 |
| COST PER ACRE APPLICATION 2 | \$ 260.30 | \$ 176.94 | \$ 72.86 | \$ | 510.00 |
| COST PER ACRE APPLICATION 3 | \$ 367.35 | \$ 249.80 | \$ 102.86 | \$ | 720.00 |
| COST PER ACRE APPLICATION 4 | \$ 219.39 | \$ 149.18 | \$ 61.43 | \$ | 430.00 |
| COST PER ACRE APPLICATION 5 | \$ 219.39 | \$ 149.18 | \$ 61.43 | \$ | 430.00 |
| COST PER ACRE APPLICATION 6 | \$ - | \$ - | \$ - | \$ | - |
| TOTAL PROGRAM COST/FACILITY | \$ 1,280.61 | \$ 870.82 | \$ 338.57 | \$ | 2,510.00 |

RESOLUTION NO. _____

**A RESOLUTION AUTHORIZING THE MAYOR TO EXECUTE A CONTRACT FOR
LANDSCAPE FERTILIZATION SERVICES BETWEEN
THE CITY OF DARIEN AND TRU GREEN**

**BE IT RESOLVED BY THE CITY COUNCIL OF THE CITY OF DARIEN, DU
PAGE COUNTY, ILLINOIS, as follows:**

SECTION 1: The City Council of the City of Darien hereby authorizes the Mayor to execute a Contract for the 2011 Fertilization Program between the City of Darien and Tru Green, relating to the various fertilizer applications, for the City's 2011 Landscape Fertilization Services at Roadside Rights of Way and Medians of 75th Street, and a certain segment of Plainfield Road. Included also are City owned facilities such as the Water Plant grounds, the Public Works facility and the City Hall grounds, a copy of which is attached hereto as "Exhibit A" and is by this reference expressly incorporated herein.

SECTION 2: This Resolution shall be in full force and effect from and after its passage and approval as provided by law.

**PASSED BY THE CITY COUNCIL OF THE CITY OF DARIEN, DU PAGE
COUNTY, ILLINOIS, this 2nd day of May 2011.**

AYES: _____

NAYS: _____

ABSENT: _____

**APPROVED BY THE MAYOR OF THE CITY OF DARIEN, DU PAGE COUNTY,
ILLINOIS this 2nd day of May 2011.**

KATHLEEN MOESLE WEAVER, MAYOR

ATTEST:

JOANNE F. COLEMAN, CITY CLERK

APPROVED AS TO FORM:

CITY ATTORNEY

CONTRACTOR'S CERTIFICATION - BID PROPOSAL

TRUSREEN, as part of its bid on a
(Name of Contractor)

contract for LANDSCAPE FERTILIZATION to the City of Darien, Illinois,
hereby certifies that said contractor is not barred from bidding on the aforementioned contract as
a result of a violation of either 720ILCS 5/33E-3 or 5/33E-4.

CERTIFIED PESTICIDE APPLICATOR CERTIFICATE NO. 03121726
ATTACH A CURRENT COPY OF PESTICIDE APPLICATOR CERTIFICATE

By: [Signature]
Authorized Agent of Contractor

SUBSCRIBED AND SWORN BEFORE ME

This 20th day of
April, 2011.

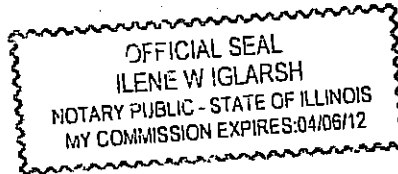

MY COMMISSION EXPIRES:

April 6, 2012
[Signature]
NOTARY PUBLIC

BID PROPOSAL
 SCHEDULE OF PRICES
 ROADSIDE RIGHT-OF-WAYS AND MEDIANS
 AND SPECIFIED FACILITIES

This bid proposal is based upon an itemization of a one-year contract proposal from May 1, 2011 through April 30, 2012, with an option of a second year extension. The second year of the option to be determined and evaluated in April of 2012. The City shall have the exclusive right to determine which applications shall be used throughout the year. The City also reserves the right to cancel any application as deemed necessary.

| I. RIGHT -OF-WAY MAINTENANCE FERTILIZATION | <u>COST</u> |
|---|--------------------------------|
| <u>FERTILIZATION DESCRIPTION</u> | |
| APPLICATION #1 MARCH – APRIL Fertilizer application with Crabgrass Pre-emergent 19-3-7, Plus 0.86% Pre-M | <u>\$ 2900.⁰⁰</u> |
| APPLICATION #2 APRIL – MAY Fertilizer application with Crabgrass Booster Pre-emergent, Broadleaf Weed Control. Formolene 30-0-0, Urea 45-0-0, Potassium Chloride 0-0-62, Broadleaf Weed Control, Trimec 992, Pre-M 6WP | <u>\$ 3200.⁰⁰</u> |
| APPLICATION #3 MAY – JUNE Fertilizer application with Broadleaf Weed Control and Grub Control. Formolene 30-0-0, Urea 45-0-0, Potassium Chloride 0-0-62, Broadleaf Weed Control Trimec 992, Merit 75 WSP | <u>\$ 4000.⁰⁰</u> |
| APPLICATION #4 JULY – AUGUST Fertilizer application with Broadleaf Weed Control. Formolene 30-0-0, Potassium Chloride 0-0-62, Broadleaf Weed Control Trimec 992 | <u>\$ 2700.⁰⁰</u> |
| APPLICATION #5 SEPTEMBER Fertilizer application with Broadleaf Weed Control. Follow up Grub Control as needed. 14-3-6 with 1% Iron, Trimec 992, Dylox 80 Insecticide | <u>\$ 2700.⁰⁰</u> |
| APPLICATION #6 NOVEMBER - DECEMBER Dormant Fertilizer application. Urea 45-0-0 | <u>\$ 2000.⁰⁰</u> |
| SUB TOTAL | <u>\$ 17,500.⁰⁰</u> |

II. SPECIFIED FACILITY MAINTENANCE

| <u>FERTILIZATION DESCRIPTION</u> | <u>COST</u> |
|---|---------------------|
| APPLICATION #1 MARCH - APRIL Fertilizer application with Crabgrass Pre-emergent 19-3-7, Plus 0.86% Pre-M | \$ <u>420.00</u> |
| APPLICATION #2 APRIL - MAY Fertilizer application with Crabgrass Booster Pre-emergent, Broadleaf Weed Control. Formolene 30-0-0, Urea 45-0-0, Potassium Chloride 0-0-62, Broadleaf Weed Control, Trimec 992, Pre-M 6WP | \$ <u>510.00</u> |
| APPLICATION #3 MAY - JUNE Fertilizer application with Broadleaf Weed Control and Grub Control. Formolene 30-0-0, Urea 45-0-0, Potassium Chloride 0-0-62, Broadleaf Weed Control Trimec 992, Merit 75 WSP | \$ <u>720.00</u> |
| APPLICATION #4 JULY - AUGUST Fertilizer application with Broadleaf Weed Control. Formolene 30-0-0, Potassium Chloride 0-0-62, Broadleaf Weed Control Trimec 992 | \$ <u>430.00</u> |
| APPLICATION #5 SEPTEMBER Fertilizer application with Broadleaf Weed Control. Follow up Grub Control as needed. 14-3-6 with 1% Iron, Trimec 992, Dylox 80 Insecticide | \$ <u>430.00</u> |
| APPLICATION #6 NOVEMBER - DECEMBER Dormant Fertilizer application. Urea 45-0-0 | \$ <u>290.00</u> |
| III TREE FERTILIZATION Tree Root Feeding for trees | \$ <u>1575.00</u> |
| <u>TOTAL COST SECTION I & SECTION II & III</u> | \$ <u>21,875.00</u> |

BID PROPOSAL
SCHEDULE OF PRICES

We propose to furnish labor and material - complete in accordance with the foregoing specifications and subject to all conditions found within such specifications, either expressed herein writing, for the described area sections and within the general conditions, and as per the scheduled prices expressed herein and about.

RESPECTFULLY SUBMITTED:

(Corporate Seal)

CORPORATE NAME

Attest:

BY: [Signature]

By: [Signature]
President

SUBSCRIBED AND SWORN BEFORE ME

This 20th day of April, 2011

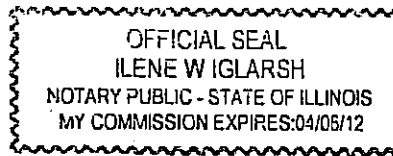

MY COMMISSION EXPIRES: April 6, 2012

[Signature]
NOTARY PUBLIC

CONTRACT

1. This agreement, made and entered into this ____ day of _____ 2011, between the City of Darien, acting by and through its Mayor and Clerk and _____.
2. That for and in consideration of the payments and agreements mentioned in City of Darien Contract Document Number FERT 11 attached hereto, _____ agrees with the City of Darien at his/their own proper cost and expense to furnish the equipment, material, labor, supplies and/or services as provided therein in full compliance with all of the terms of such City of Darien Contract Document Number FERT 11 attached hereto.
3. It is understood and agreed that City of Darien Contract Document Number FERT 11 hereto attached, prepared by the City of Darien, is an essential document of this contract and is a part hereof.
4. In witness whereof, the said parties have executed these presents on the date above mentioned.

(City Seal)

CITY OF DARIEN

Attest:

By: _____
City Clerk

By: _____
Mayor

(Corporate Seal)

CORPORATE NAME

Attest:

By: _____
Secretary

By: _____
President

AGENDA MEMO
Municipal Services Committee
April 25, 2011

ISSUE STATEMENT

Approval of a resolution for the authorization to accept a proposal for the purchase of rock salt from North American Salt Company in an amount not to exceed \$199,800.00.

BACKGROUND/HISTORY

The City of Darien has utilized the services of the Illinois Department of Transportation Central Management Services for Road Salt prior to this year. The rock salt is utilized by the Municipal Services Department for street de-icing operations during the snow season. Meanwhile, the department is in the process of completing the salt storage building which will allow us to store our total annual supply. This opportunity to purchase salt in a bulk quantity allowed the City to seek competitive pricing by taking advantage of summer salt pricing.

Attached and labeled as Attachment A, please find the prices received at the bid opening held on March 16, 2011. Staff received 3 bids with the lowest bidder being North American Salt Company. The 2011-12 per ton unit pricing is \$66.60, for a total quantity to be utilized in the amount of 2,750 tons for an amount of \$183,150.00. In addition, the Darien Park District and Center Cass School District #66 will be purchasing up to 245 and 5 tons respectively of rock salt not to exceed \$16,650.00. A forthcoming agenda memo will cover the Intergovernmental Agreements between the City and the Darien Park District and Center Cass School District #66. This is the first year that the City has secured a salt contract on our own and has realized a cost savings of 11% or \$8.22 in comparison to the \$74.82 per ton unit price from last years state joint contract.

The proposed expenditure would be expended from the following account:

| ACCOUNT NUMBER | ACCOUNT DESCRIPTION | FY 11-12 BUDGET | PROPOSED EXPENDITURE | PROPOSED BALANCE |
|-----------------------|-----------------------------------|------------------------|-----------------------------|-------------------------|
| 03-60-4249 | SALT | \$235,500.00 | \$183,150.00 | \$52,350.00 |
| 03-60-4249 | DARIEN PARK DISTRICT-REIMBURSABLE | N/A | \$ 16,317.00 | N/A |
| 03-60-4249 | DISTRICT 66-REIMBURSABLE | N/A | \$ 333.00 | N/A |
| TOTAL COST | | | \$ 199,800.00 | |

STAFF RECOMMENDATION

The Municipal Services Committee recommends approval of this resolution with North American Salt Company for the annual purchase of Rock Salt in an amount not to exceed \$199,800.

ALTERNATE CONSIDERATION

Not approving the contract.

DECISION MODE

This item will be placed on the May 2, 2011 City Council agenda for formal approval.

RESOLUTION NO. _____

A RESOLUTION TO ACCEPT A PROPOSAL FOR THE PURCHASE OF ROCK SALT FROM NORTH AMERICAN SALT COMPANY IN AN AMOUNT NOT TO EXCEED \$199,800.00

BE IT RESOLVED BY THE CITY COUNCIL OF THE CITY OF DARIEN, DU PAGE COUNTY, ILLINOIS, as follows:

SECTION 1: The City Council of the City of Darien hereby accepts a proposal for the purchase of rock salt from North American Salt Company in an amount not to exceed \$199,800.00, hereby attached as Exhibit A.

SECTION 2: This Resolution shall be in full force and effect from and after its passage and approval as provided by law.

PASSED BY THE CITY COUNCIL OF THE CITY OF DARIEN, DU PAGE COUNTY, ILLINOIS, this 2nd day of May 2011.

AYES: _____

NAYS: _____

ABSENT: _____

APPROVED BY THE MAYOR OF THE CITY OF DARIEN, DU PAGE COUNTY, ILLINOIS, this 2nd day of May 2011.

KATHLEEN MOESLE WEAVER, MAYOR

ATTEST:

JOANNE F. COLEMAN, CITY CLERK

APPROVED AS TO FORM:

CITY ATTORNEY

**PROPOSAL SHEET
BULK HIGHWAY DEICING SALT**

**SEALED PROPOSALS MUST BE RECEIVED BY THE CITY OF DARIEN NO LATER
THAN 12:00 PM ON WEDNESDAY, MARCH 16, 2011**

ALL PROPOSAL PRICING SHALL BE FIRM THROUGH MAY 31, 2011.

TONS OF DEICING SALT PROVIDED: 3000 (UP TO 3900)

PRICE PER TON DELIVERED*: \$ 66.60

TOTAL PROPOSAL PRICE: \$ 199,800

TOTAL PROPOSAL PRICE WRITTEN: ONE HUNDRED NINETY NINE THOUSAND
EIGHT HUNDRED & 00/100

COMPANY NAME: North American Salt Co., A Compass Minerals Co.

CONTACT NAME: Sean Lierz

ADDRESS: 9900 W. 109th St., Suite 100

CITY, STATE & ZIP: Overland Park, KS 66210

PHONE NUMBER: 800-323-1641 or 913-344-9330

FAX NUMBER: 913-338-7945

E-MAIL ADDRESS: LierzS@compassminerals.com

I hereby certify that the above-described salt meets or exceeds all specifications of the proposal notice for the City of Darien, Illinois.

DATE: 3/9/11

SIGNED: Sean Lierz

PRINT NAME: SEAN LIERZ
AUTHORIZED COMPANY REPRESENTATIVE

ALL PROPOSAL PRICING SHALL BE FIRM THROUGH MAY 31, 2011.

*As specified in the proposal notice.

AGENDA MEMO
Municipal Services Committee
April 25, 2011

Issue Statement

Approval of a Resolution to extend a contract with Hoving Clean Sweep, LLC for the 2011 Street Sweeping services in an amount not to exceed \$22,688.00 through April 30, 2012. The proposed contract extension would be the last extension of a three (3) year option.

Background/History

The Municipal Services Department opened 4 sealed bids on April 8, 2009. See attached bid tally labeled as Attachment A. The bid contained two additional one year option extensions for 2010 and 2011 and this proposal would be the last option extension, see Attachment A-1. Please recall the City's street sweeping services for the year have been reduced to three intervals from four. See Attachment B for revised schedule. The reduced interval has been in place since 2010 and has not impacted the level of service. Attachment C is correspondence from Hoving Clean Sweep accepting the extension. The street sweeping schedule for 2011 is proposed to begin between the following dates:

Interval 1-May 12th - May 20th

Interval 2-July 6th - July 16th

Interval 3-August 25th -September 6th-ELIMINATED

Interval 4-October 27th - November 17th

Funding for the Street Sweeping Services would be expended from the following line item of the FY 11/12 Budget:

| ACCOUNT NUMBER | ACCOUNT DESCRIPTION | FY 11/12 BUDGET | PROPOSED EXPENDITURE |
|----------------|---------------------|-----------------|----------------------|
| 01-30-4373 | STREET SWEEPING | \$ 22,688 | \$ 22,688 |

Staff Recommendation

Staff recommends approval of the contract with Hoving Clean Sweep, LLC for the 2011 Street Sweeping services contract extension in an amount not to exceed \$22,688.00. The vendor has provided excellent service to the City and has acknowledged and accepted the 2011 schedule.

Alternate Consideration

Not approving the street sweeping services contract.

Decision Mode

This item will be placed on the agenda for formal consideration at the May 2, 2011 City Council meeting.

CITY OF DARIEN PUBLIC WORKS
1702 PLAINFIELD ROAD
DARIEN, IL 60561

SEALED BID: 2009 Street Sweeping Program

OPENING DATE/TIME: April 8, 2009 @ 10:00 a.m.

Attachment A

| ITEM DESCRIPTION | Hoving Clean Sweep | | Elgin Sweeping Services | | Waste Management | | Illinois Central Sweeping | | | |
|------------------|---------------------------------|-----|----------------------------|--------------|----------------------------|--------------|---------------------------|--------------|----------|--------------|
| | Bid Bond - Certified Check | | Bid Bond - Certified Check | | Bid Bond - Certified Check | | Hourly Rate Per Vehicle | | | |
| 2009 | | | | | | | | | | |
| A | May 11 - 19 | 70 | \$ 79.50 | \$ 5,565.00 | \$ 91.75 | \$ 6,422.50 | \$ 90.00 | \$ 6,300.00 | \$ 85.00 | \$ 5,950.00 |
| | July 8 - 15 | 70 | \$ 79.50 | \$ 5,565.00 | \$ 91.75 | \$ 6,422.50 | \$ 90.00 | \$ 6,300.00 | \$ 85.00 | \$ 5,950.00 |
| | August 24 - Sept 7 | 70 | \$ 79.50 | \$ 5,565.00 | \$ 91.75 | \$ 6,422.50 | \$ 90.00 | \$ 6,300.00 | \$ 85.00 | \$ 5,950.00 |
| | Oct 26 - Nov 16 | 135 | \$ 79.50 | \$ 10,732.50 | \$ 91.75 | \$ 12,386.25 | \$ 90.00 | \$ 12,150.00 | \$ 85.00 | \$ 11,475.00 |
| | Sub-Total | | \$ | \$ 27,427.50 | \$ | \$ 31,653.75 | \$ | \$ 31,050.00 | \$ | \$ 29,325.00 |
| B | Emergency Services | | | | | | | | | |
| | Emergency Call-Out | 3 | \$ 95.00 | \$ 285.00 | \$ 101.00 | \$ 303.00 | \$ 98.00 | \$ 294.00 | \$ 85.00 | \$ 255.00 |
| | Sub-Total | | \$ | \$ 285.00 | \$ | \$ 303.00 | \$ | \$ 294.00 | \$ | \$ 255.00 |
| | Total Sections A & B | | \$ | \$ 27,712.50 | \$ | \$ 31,956.75 | \$ | \$ 31,344.00 | \$ | \$ 29,580.00 |
| 2010 | | | | | | | | | | |
| | Hoving Clean Sweep | | | | | | | | | |
| | Elgin Sweeping Services | | | | | | | | | |
| | Waste Management | | | | | | | | | |
| | Illinois Central Sweeping | | | | | | | | | |
| | Hourly Rate Per Vehicle | | | | | | | | | |
| ITEM DESCRIPTION | | | | | | | | | | |
| A | May 12 - 20 | 70 | \$ 82.28 | \$ 5,759.60 | \$ 94.50 | \$ 6,615.00 | \$ 94.00 | \$ 6,580.00 | \$ 87.12 | \$ 6,098.40 |
| | July 6 - 16 | 70 | \$ 82.28 | \$ 5,759.60 | \$ 94.50 | \$ 6,615.00 | \$ 94.00 | \$ 6,580.00 | \$ 87.12 | \$ 6,098.40 |
| | August 25 - Sept 6 | 70 | \$ 82.28 | \$ 5,759.60 | \$ 94.50 | \$ 6,615.00 | \$ 94.00 | \$ 6,580.00 | \$ 87.12 | \$ 6,098.40 |
| | Oct 27 - Nov 17 | 135 | \$ 82.28 | \$ 11,107.80 | \$ 94.50 | \$ 12,757.50 | \$ 94.00 | \$ 12,690.00 | \$ 87.12 | \$ 11,761.20 |
| | Sub-Total | | \$ | \$ 28,386.60 | \$ | \$ 32,602.50 | \$ | \$ 32,430.00 | \$ | \$ 30,056.40 |
| B | Emergency Services | | | | | | | | | |
| | Emergency Call-Out | 3 | \$ 98.33 | \$ 294.99 | \$ 104.50 | \$ 313.50 | \$ 98.00 | \$ 294.00 | \$ 87.12 | \$ 261.36 |
| | Sub-Total | | \$ | \$ 294.99 | \$ | \$ 313.50 | \$ | \$ 294.00 | \$ | \$ 261.36 |
| | Total Sections A & B | | \$ | \$ 28,681.59 | \$ | \$ 32,916.00 | \$ | \$ 32,724.00 | \$ | \$ 30,317.76 |
| 2011 | | | | | | | | | | |
| | Hoving Clean Sweep | | | | | | | | | |
| | Elgin Sweeping Services | | | | | | | | | |
| | Waste Management | | | | | | | | | |
| | Illinois Central Sweeping | | | | | | | | | |
| | Hourly Rate Per Vehicle | | | | | | | | | |
| ITEM DESCRIPTION | | | | | | | | | | |
| A | May 12 - 20 | 70 | \$ 85.16 | \$ 5,961.20 | \$ 94.50 | \$ 6,615.00 | \$ 98.00 | \$ 6,860.00 | \$ 89.30 | \$ 6,251.00 |
| | July 6 - 16 | 70 | \$ 85.16 | \$ 5,961.20 | \$ 94.50 | \$ 6,615.00 | \$ 98.00 | \$ 6,860.00 | \$ 89.30 | \$ 6,251.00 |
| | August 25 - Sept 6 | 70 | \$ 85.16 | \$ 5,961.20 | \$ 94.50 | \$ 6,615.00 | \$ 98.00 | \$ 6,860.00 | \$ 89.30 | \$ 6,251.00 |
| | Oct 27 - Nov 17 | 135 | \$ 85.16 | \$ 11,496.60 | \$ 94.50 | \$ 12,757.50 | \$ 98.00 | \$ 13,230.00 | \$ 89.30 | \$ 12,055.50 |
| | Sub-Total | | \$ | \$ 29,380.20 | \$ | \$ 32,602.50 | \$ | \$ 33,810.00 | \$ | \$ 30,808.50 |
| B | Emergency Services | | | | | | | | | |
| | Emergency Call-Out | 3 | \$ 101.77 | \$ 305.31 | \$ 104.50 | \$ 313.50 | \$ 98.00 | \$ 294.00 | \$ 89.30 | \$ 267.90 |
| | Sub-Total | | \$ | \$ 305.31 | \$ | \$ 313.50 | \$ | \$ 294.00 | \$ | \$ 267.90 |
| | Total Sections A & B | | \$ | \$ 29,685.51 | \$ | \$ 32,916.00 | \$ | \$ 34,104.00 | \$ | \$ 31,076.40 |

**BID PROPOSAL
SCHEDULE OF PRICES
STREET SWEEPING SERVICES**

This bid award is based upon a total hourly rate for a one-year contract from May 1, 2009 through April 30, 2010, with two one year extensions from May 1, 2010 through April 30, 2012. The date below indicates approximate start date periods.

| 2009 SWEEPING PROGRAM 4-SWEEPINGS | | | | |
|--|-----------------|--------|---------------|--------------------|
| STREET SWEEPING SERVICES SCHEDULE | ESTIMATED UNITS | UNIT | COST PER HOUR | TOTAL COST |
| MAY 11 TH - MAY 19 TH | 70 | HOURLY | \$79.50 | \$5,565.00 |
| JULY 8 TH - JULY 15 TH | 70 | HOURLY | \$79.50 | \$5,565.00 |
| AUGUST 24 TH - SEPTEMBER 7 TH | 70 | HOURLY | \$79.50 | \$5,565.00 |
| OCTOBER 26 TH - NOVEMBER 16 TH | 135 | HOURLY | \$79.50 | \$10,732.50 |
| SUB-TOTAL-A | 345 | | | \$27,427.50 |
| EMERGENCY SERVICES | ESTIMATED UNITS | UNIT | COST PER HOUR | TOTAL COST |
| EMERGENCY CALL OUT | 3 | HOURLY | \$95.00 | \$285.00 |
| SUB-TOTAL-B | 3 | | | \$285.00 |
| TOTALS-SUBTOTAL A & B 2009 | | | | \$27,712.50 |
| DATES INDICATE TENTATIVE START DATE PERIOD | | | | |
| 2010 SWEEPING PROGRAM 4-SWEEPINGS | | | | |
| STREET SWEEPING SERVICES SCHEDULE | ESTIMATED UNITS | UNIT | COST PER HOUR | TOTAL COST |
| MAY 12 th - MAY 20 th | 70 | HOURLY | \$82.28 | \$5,759.60 |
| JULY 6 TH - JULY 16 th | 70 | HOURLY | \$82.28 | \$5,759.60 |
| AUGUST 25 th - SEPTEMBER 6 th | 70 | HOURLY | \$82.28 | \$5,759.60 |

| | | | | |
|--|-----------------|--------|---------------|--------------------|
| OCTOBER 27 th - NOVEMBER-17 th | 135 | HOURLY | \$82.28 | \$11,107.80 |
| SUB-TOTAL-A | 345 | | | \$28,386.60 |
| EMERGENCY SERVICES | ESTIMATED UNITS | UNIT | COST PER HOUR | TOTAL COST |
| EMERGENCY CALL OUT | 3 | HOURLY | 98.33 | \$294.99 |
| SUB-TOTAL-B | 3 | | | \$294.99 |
| TOTALS-SUBTOTAL A & B 2010 | | | | \$28,681.59 |

DATES INDICATE TENTATIVE START DATE PERIOD

2011 SWEEPING PROGRAM - SWEEPINGS

3

STREET SWEEPING SERVICES SCHEDULE

| | | | | |
|--|-----------------|-------------------|--------------------|-----------------------|
| MAY 12 th - MAY 20 th | 70 | HOURLY | \$85.16 | \$5,961.20 |
| JULY 6 th - JULY 16 th | 70 | HOURLY | \$85.16 | \$5,961.20 |
| AUGUST 25th - SEPTEMBER 6th | 70 | HOURLY | \$85.16 | \$5,961.20 |
| <i>- ELIMINATED -</i> | | | | |
| OCTOBER 27 th - NOVEMBER-17 th | 135 | HOURLY | \$85.16 | \$11,496.60 |
| SUB-TOTAL-A | 345 | | | \$29,380.20 |
| EMERGENCY SERVICES | ESTIMATED UNITS | UNIT | COST PER HOUR | TOTAL COST |
| EMERGENCY CALL OUT | 3 | HOURLY | \$101.77 | \$305.31 |
| SUB-TOTAL-B | 3 | | | \$305.31 |
| TOTALS-SUBTOTAL A & B 2011 | | | | \$29,685.51 |

DATES INDICATE TENTATIVE START DATE PERIOD

REVISED
04/14/11

SEE ATT SCHEDULE
LABELED AS
Attachment B

City of Darien
Street Sweeping Schedule
2011

Attachment B

| REVISED SCHEDULE | | | | |
|-------------------------|-------------------------------|--------------------|---------------------|-----------------|
| 2011 | | Hoving Clean Sweep | | |
| ITEM | DESCRIPTION | | | |
| A | May 12 - 20 | 75 | \$ 85.16 | \$ 6,387.00 |
| | July 6 - 16 | 60 | \$ 85.16 | \$ 5,109.60 |
| | August 25 - Sept 6 | 0 | \$ 85.16 | \$ - |
| | Oct 27 - Nov 17 | 125 | \$ 85.16 | \$ 10,645.00 |
| | Sub-Total | 260 | | \$ 22,141.60 |
| B | Emergency Services | | | |
| | Emergency Call-Out | 3 | \$ 101.77 | \$ 305.31 |
| | Sub-Total | | | \$ 305.31 |
| Total Sections A & B | | | | \$ 22,446.91 |



Hoving Clean Sweep, LLC.
 2351 Powis Road
 West Chicago, IL 60185
 Phone: 630-377-7000 Fax: 630-377-7462

04-10-11

City of Darien
 1702 Plainfield Rd
 Darien, IL 60561
 Attn: Dan Gombac

Dear Dan,

K. Hoving Clean Sweep enjoyed working with you for the 2010 season. We enjoyed hearing all the positive feedback from your residents and hope you had the same positive feelings that we did. We are looking forward to working with you in 2011 as we start the last year of our contract. We will keep up the same effort to satisfy you and your town in the upcoming year. We just wanted to confirm for next year the following schedule;

The proposed schedule is as follows;

- Sweep 1: Week of May 12, 2011
- Sweep 2: Week of July 5, 2011
- Sweep 3: Week of October 27, 2011

If you see any changes you would like to make above, please change the above date in question and sign below. Please call me with any questions or concerns.

K.J. Loerop

Both parties agree to the above service schedule,

Dated this day _____, the _____ day of _____, 2010

K.J. Loerop

Dan Gombac

RESOLUTION NO. _____

A RESOLUTION AUTHORIZING THE MAYOR TO EXECUTE A CONTRACT EXTENSION FOR THE 2011 STREET SWEEPING SERVICES BETWEEN THE CITY OF DARIEN AND HOVING CLEAN SWEEP LLC IN AN AMOUNT NOT TO EXCEED \$22,688.00

BE IT RESOLVED BY THE CITY COUNCIL OF THE CITY OF DARIEN, DU PAGE COUNTY, ILLINOIS, as follows:

SECTION 1: The City Council of the City of Darien hereby authorizes the Mayor to execute a certain Contract Extension for the 2011 Street Sweeping Services between the City of Darien and Hoving Clean Sweep LLC. The extended contract would be effective from May 1, 2011 through April 30, 2012.

SECTION 2: This Resolution shall be in full force and effect from and after its passage and approval as provided by law.

PASSED BY THE CITY COUNCIL OF THE CITY OF DARIEN, DU PAGE COUNTY, ILLINOIS, this 2nd day of May, 2011.

AYES: _____

NAYS: _____

ABSENT: _____

APPROVED BY THE MAYOR OF THE CITY OF DARIEN, DU PAGE COUNTY, ILLINOIS, this 2nd day of May, 2011.

KATHLEEN MOESLE WEAVER, MAYOR

ATTEST:

JOANNE F. COLEMAN, CITY CLERK

APPROVED AS TO FORM

CITY ATTORNEY

AGENDA MEMO
Municipal Services Committee
April 25, 2011

Issue Statement

Consideration for the authorization to execute an Illinois Department of Transportation Resolution, (IDOT BLR 14230) authorizing the expenditure of Motor Fuel Tax (MFT) funds for the FY 2011/12 General Maintenance items in the amount of \$556,000 for a period from May 1, 2011 through April 30, 2012.

Background/History

The City of Darien utilizes Motor Fuel Tax Funds (MFT) for expenditures related to various street maintenance functions. The funding provides for expenditures for such items as salaries, the purchase of rock salt, cold and hot bituminous surface mixes, storm sewer related items, various aggregate materials and road striping. Because MFT funds are utilized, the City Council is required to adopt a resolution authorizing the expenditure of the proposed funding related to the general maintenance items. Attached as, Attachment A is the Bureau of Local Road Form Municipal Estimate of Maintenance Costs. (BLR 14231).

Staff Recommendation

Staff recommends approval of this Resolution.

Alternate Consideration

Not approving the Resolution.

DECISION MODE

This item will be placed on the May 2, 2011 City Council agenda for formal consideration.



Period from 05/01/2011 to 04/30/2012

Section Number 12 - 00000 - 00 - GM
Municipality City of Darien

Estimated Cost of Maintenance Operations

| Maintenance Operation (No. - Description) | Group (I,II,III,IV) | For Group I, II, or III (Material, Equipment or Labor) | | | | | Operation Cost |
|--|------------------------|--|-------|----------|------------|--------------|---------------------|
| | | Item | Unit | Quantity | Unit Price | Cost | |
| 1) Aggregate | IIA | Stone CA-6 CA-7 | Tons | 1600 | 10.75 | \$17,200.00 | 25,950.00 |
| | IIA | Labor -5 Gen Utility Wkrs | Av Hr | 250 | 35.00 | \$8,750.00 | |
| 2) Pavement Patching (2 different vendors will be used for bituminous purchase) | IIB | Surface Bituminous-Hot | Tons | 310 | 51.00 | \$15,810.00 | 69,060.00 |
| | IIB | Labor -5 Gen Utility Wkrs | Av Hr | 1000 | 35.00 | \$35,000.00 | |
| | IIB | Surface Bituminous-Cold | Tons | 100 | 60.00 | \$6,000.00 | |
| | IIB | Labor -5 Gen Utility Wkrs | Av Hr | 350 | 35.00 | \$12,250.00 | |
| 2) Snow & Ice Control | IIA | Road Salt -State Contract | Tons | 3000 | 66.60 | \$199,800.00 | 297,800.00 |
| | IIA | Labor -5 Gen Utility Wkrs | Av Hr | 2800 | 35.00 | \$98,000.00 | |
| 3) Storm Sewer Maint. | IIA | Culvert Pipe | L.S. | 1 | 10,000. | \$10,000.00 | 62,500.00 |
| | IIA | Labor -5 Gen Utility Wkrs | Av Hr | 1500 | 35.00 | \$52,500.00 | |
| 4) Pavement Marking | IIB | Striping-Paint-Thermal | L.S. | 1 | 6,000.0 | \$6,000.00 | 6,700.00 |
| | IIB | Labor -5 Gen Utility Wkrs | Av Hr | 20 | 35.00 | \$ 700.00 | |
| 5) Street Sign Maint. | IIA | Labor -5 Gen Utility Wkrs | Av Hr | 300 | 35.00 | \$10,500.00 | 10,500.00 |
| 6) Mowing | IIA | Labor -5 Gen Utility Wkrs | Av Hr | 1500 | 27.00 | \$40,500.00 | 40,500.00 |
| 8) Catch Basin Cleaning | IIB | Labor -5 Gen Utility Wkrs | Av Hr | 110 | 35.00 | \$3,850.00 | 3,850.00 |
| Total Day Labor Costs | | | | | | | |
| Total Estimated Maintenance Operation Cost | | | | | | | \$516,860.00 |
| Preliminary Engineering | | | | | | 0.00 | |
| Engineering Inspection | | | | | | 0.00 | |
| Material Testing | | | | | | 0.00 | |
| Total Estimated Engineering Cost | | | | | | | |
| Total Estimated Maintenance Cost | | | | | | | \$516,860.00 |

Submitted: 05/01/2011 Date Approved: _____ Date

By: _____
Municipal Official Director of Mun.Sv Title Regional Engineer

Submit Four (4) Copies to Regional Engineer



CITY OF DARIEN

In the County of DuPage and the State of Illinois
Incorporated 1969

May 2, 2011

Ms. Diane O'Keefe, P.E.
Deputy Director of Highways,
Region One Engineer
Division of Highways/Region One/District One
201 West Center Ct.
Schaumburg, IL 60196-1096

RE: Section Number 12-00000-00-RF

Dear Ms. O'Keefe:

In accordance with the Bureau of Local Roads and Streets Administrative Policy Manual, the following is an estimate of the allotted MFT monies to spend by the City during the Fiscal Year Ending April 30, 2012.

Estimated Total Expenditures for:

| | |
|--------------|--------------|
| FICA | \$ 16,501.35 |
| IMRF | \$ 23,805.23 |
| TOTAL | \$ 40,306.58 |

If you have any questions regarding this matter, please contact Dan Gombac, Director of Municipal Services at 630-353-8106.

Sincerely,

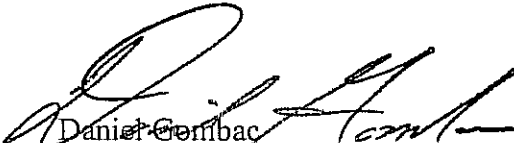
Daniel Gombac
Director of Municipal Services

cc: Bryon Vana, City Administrator
Paul Nosek, City Accountant



| |
|------------------------------|
| For District Use Only |
| Transaction Number _____ |
| Date _____ |
| Checked by _____ |

Municipality Darien

County DuPage

Rd. District _____

Section 12-00000-00-RF

I hereby request authorization to expend Motor Fuel Tax Funds as indicated below.

| Purpose | Amount |
|--|----------------------------|
| Contract Construction..... | _____ |
| Day Labor Construction | _____ |
| Right-of-Way (Itemized On Reverse Side)..... | _____ |
| Engineering | _____ |
| Maintenance Engineering | _____ |
| Engineering Investigations | _____ |
| Other Category..... | _____ |
| Obligation Retirement..... | _____ |
| Maintenance..... | _____ |
| Co. Eng./Supt. Salary & Expenses (Period from _____ to _____) | _____ |
| IMRF or Social Security..... | <u>40,306.58</u> |
| Interest _____ | _____ |
| _____ | _____ |
| _____ | _____ |
| Total | \$ <u>40,306.58</u> |

Comments _____

Date May, 2 , 2011

Signed by _____

Director of Municipal Services
Title of Official

| |
|-------------------------------------|
| Approved |
| _____ |
| Date |
| Department of Transportation |
| _____ |
| Regional Engineer |

Itemization of Right-of-Way Request

| Location of Property | | | Name of Owner | Acres Right- of-Way | Cost of Land Taken | Cost of Damage to Land Not Taken | Total |
|----------------------|---------------------|-----------------|---------------|---------------------------|--------------------------|--|-------|
| Street | Between (Street) | And (Street) | | | | | |
| | | | | | | | |
| | | | | | | Total \$ | |

FYE 2012 PROPOSED MFT PROGRAM HOURS

| No. | Employee | Hourly Wage | O.T. Rate | Reg Hours Per Day | Reg Hours Per Year |
|-----|---------------------------------------|---------------|-------------|-------------------|--------------------|
| 1 | Bruzan | \$26.66 | \$39.99 | 4 | 1,040 |
| 2 | Cable | \$26.66 | \$39.99 | 4 | 1,040 |
| 3 | Carr | \$30.59 | \$45.89 | 4 | 1,040 |
| 4 | Coulman | \$36.85 | \$55.28 | 4 | 1,040 |
| 5 | Corneils | \$27.26 | \$40.89 | 4 | 1,040 |
| 6 | Herman | \$30.59 | \$45.89 | 4 | 1,040 |
| 7 | Kilianek | \$26.66 | \$39.99 | 4 | 1,040 |
| 8 | Koudelik | \$24.73 | \$37.10 | 4 | 1,040 |
| 9 | Lepic | \$32.56 | \$48.84 | 4 | 1,040 |
| 10 | Masek | \$30.59 | \$45.89 | 4 | 1,040 |
| 11 | Reid | \$26.66 | \$39.99 | 4 | 1,040 |
| 12 | Throm | \$27.12 | \$40.68 | 4 | 1,040 |
| 13 | Fell | \$33.29 | \$49.94 | 4 | 1,040 |
| | Hourly Rate Per Day | \$380.22 | \$570.33 | 52 | 13,520 |
| | Average Rate | \$29.25 | \$43.87 | | |
| | City porton of Health Ins | \$5.85 | | | |
| | Average Hourly Rate with Benefits | \$35.10 | | | |
| | FICA | \$2.23 | \$16,501.35 | | |
| | IMRF | \$3.22 | \$23,805.23 | | |
| | Average Hourly Rate with all Benefits | \$40.54 | | | |
| | Total MFT Funds | \$ 300,000.00 | | | |
| | Total Hours | 7,399 | | | |
| | Total FICA & IMRF | | \$40,306.58 | | |



BE IT RESOLVED, by the City Council of the
(Council or President and Board of Trustees)
City Darien of Darien, Illinois, that there is hereby
(City, Town or Village) (Name)
appropriated the sum of \$556,000.00 of Motor Fuel Tax funds for the purpose of maintaining
streets and highways under the applicable provisions of the Illinois Highway Code from May 1, 2011
(Date)
to April 30, 2012
(Date)

BE IT FURTHER RESOLVED, that only those streets, highways, and operations as listed and described on the approved Municipal Estimate of Maintenance Costs, including supplemental or revised estimates approved in connection with this resolution, are eligible for maintenance with Motor Fuel Tax funds during the period as specified above.

BE IT FURTHER RESOLVED, that the Clerk shall, as soon as practicable after the close of the period as given above, submit to the Department of Transportation, on forms furnished by said Department, a certified statement showing expenditures from and balances remaining in the account(s) for this period; and

BE IT FURTHER RESOLVED, that the Clerk shall immediately transmit two certified copies of this resolution to the district office of the Department of Transportation, at Schaumburg, Illinois.

I, Joanne Coleman Clerk in and for the City
(City, Town or Village)
of Darien, County of DuPage

hereby certify the foregoing to be a true, perfect and complete copy of a resolution adopted by
the City Council at a meeting on May 2, 2011
(Council or President and Board of Trustees) Date

IN TESTIMONY WHEREOF, I have hereunto set my hand and seal this 2nd day of May, 2011

(SEAL) _____ City Clerk
(City, Town or Village)

Approved

Date
Department of Transportation

Regional Engineer

**MINUTES
CITY OF DARIEN
MUNICIPAL SERVICES COMMITTEE
February 28, 2011**

PRESENT: Chairperson Joseph Marchese, Alderman John Galan, Alderman Ted Schauer,
Dan Gombac-Director, Elizabeth Lahey-Secretary

ABSENT: None

Chairperson Marchese called the Municipal Services Committee Meeting to order at 6:30 p.m. at City Hall - City Hall Conference Room, Darien, Illinois and declared a quorum present.

NEW BUSINESS

A. Zoning Map – Approval of the 2011 Zoning Map

Mr. Dan Gombac, Director reported that every year the City is required by law to publish a current Zoning Map. He reported that the updated map includes all of the annexations and zoning activity that occurred in 2010.

There was no one in the audience wishing to present public comment.

Alderman Schauer made a motion and it was seconded by Alderman Galan that the Municipal Services Committee recommends approval of the updated Zoning Map as presented.

Upon voice vote, THE MOTION CARRIED unanimously 3-0.

B. Resolution – Preliminary approval of a contract with Suburban Concrete Inc. for the 2011 Concrete Program.

Mr. Dan Gombac, Director presented the staff report. He stated that the 2011 Concrete Program and pricing were presented at the budget meeting. He stated that this also included pricing for residents and waives the \$75.00 residential permit fee application for concrete work.

There was no one in the audience wishing to present public comment.

Alderman Galan made a motion and it was seconded by Alderman Schauer to recommend approval of A RESOLUTION APPROVING A CONTRACT FOR THE 2011 CONCRETE SIDEWALK, APRON, CURB AND GUTTER REMOVAL AND REPLACEMENT PROGRAM AND WAIVING THE \$75.00 PERMIT FEE APPLICATION TO PARTICIPATING RESIDENTS.

Upon voice vote, THE MOTION CARRIED unanimously 3-0.

C. Resolution – Preliminary approval of a contract extension with Suburban Concrete Inc. for concrete flatwork for Capital Projects as they relate to Storm Water Ditch Projects.

Mr. Dan Gombac, Director presented the staff report. He reported that this resolution authorizes the City to add quantities to the proposed current contract for Suburban Concrete Inc. for the removal and replacement of concrete aprons or curb and gutter required for various Public Works projects.

There was no one in the audience wishing to present public comment.

Alderman Galan made a motion and it was seconded by Alderman Schauer to approve A RESOLUTION TO ADD QUANTITIES TO THE CURRENT CONTRACT FROM SUBURBAN CONCRETE INC. FOR THE APRON RESTORATIONS FOR THE 2011 DITCH MAINTENANCE IMPROVEMENT PROJECT IN AN AMOUNT NOT TO EXCEED \$55,000.00.

Upon voice vote, THE MOTION CARRIED unanimously 3-0.

D. Resolution – Preliminary approval of a contract with James D. Fiala Paving Inc. for the 2011 Street Maintenance Program.

Mr. Dan Gombac, Director presented the staff report. He reported that this resolution is preliminary approval of the 2011 Street Maintenance contract with James D. Fiala Paving Inc. in the amount of \$1,234,927.48 which includes Alternate 2 noted on the Agenda Memo. Mr. Gombac stated that this year's bids were favorable in comparison to last year's contract.

Alderman Schauer asked if the City has worked with James D. Fiala Paving Inc.

Mr. Gombac reported that the City has worked with the contractor in 2005, 2007, 2008 and 2009.

Alderman Galan questioned if the price would increase due to the rising increase in gas.

Mr. Gombac reported that James D. Fiala Paving Inc. has locked the prices with their vendors. He stated that he was confident that the price would not increase due to gas increases or any other increases.

There was no one in the audience wishing to present public comment.

Alderman Galan made a motion and it was seconded by Alderman Schauer to approve A RESOLUTION TO ENTER INTO A CONTRACT AGREEMENT FOR THE 2011 STREET MAINTENANCE PROGRAM BETWEEN THE CITY OF DARIEN AND JAMES D. FIALA PAVING COMPANY INC. IN AN AMOUNT NOT TO EXCEED \$1,234,927.48.

Upon voice vote, THE MOTION CARRIED unanimously 3-0.

E. Resolution – A Resolution to enter into an agreement for professional services with Christopher B. Burke Engineering Ltd. related to the Management and Monitoring of 10 acres of Wetland/Natural Area within the Tara Hill subdivision for a five year period.

Mr. Dan Gombac, Director reported that this resolution enters into an agreement with Christopher B. Burke Engineering Ltd. He reported that Christopher B. Burke Engineering Ltd. has been managing the Tara Hill wetlands under a previous 3-year contract that expired April 30, 2010. He stated that due to infrastructure maintenance that require immediate repairs no management or monitoring of the wetlands was performed the last year. He further stated that the proposed contract is for five years and allows an optimal timeline for items to be reviewed assessed, corrected and mitigated versus the customary three year contract.

Alderman Galan questioned what monitoring is done by Christopher B. Burke Engineering Ltd.

Mr. Gombac reported that their environmental specialists evaluates the current plant species, and provides corrective measures, including and organizing controlled burns to maintain the wetland in accordance with best management practices (BMP). The consultant is also required to provide an annual report.

Alderman Schauer questioned how often there is a controlled burn.

Mr. Gombac reported that controlled burns are done once a year.

There was no one in the audience wishing to present public comment.

Alderman Schauer made a motion and it was seconded by Alderman Galan to approve A RESOLUTION AUTHORIZING THE MAYOR AND THE CITY CLERK TO EXECUTE AN AGREEMENT FOR PROFESSIONAL SERVICES BETWEEN THE CITY OF DARIEN AND CHRISTOPHER B. BURKE ENGINEERING, LTD. (TARA HILL MANAGEMENT AND MONITORING OF 10 ACRES OF WETLAND/NATURAL AREAS WITHIN THE TARA HILL SUBDIVISION.

Upon voice vote, THE MOTION CARRIED unanimously 3-0.

F. Resolution – A Resolution accepting a proposal from Associated Technical Services (ATS) for the 2010-11 Water Leak Survey in a total amount not to exceed \$14,208.48.

Mr. Dan Gombac, Director presented the staff report. He reported the leak survey program as proposed by Associated Technical Services (ATS) includes two phases consisting of surveying water main and the second phase includes the pinpointing of leaks found in the system. The quote is structured in a fashion that the vendor is additionally motivated to find as many leaks as possible since the proposal is further driven on unit costs for pinpointing leaks. Based on leak detection results from 2000, 2002, 2003 and 2007 ATS had located an average of 15 various leaks per year whereas the competition has identified an average of 4 leaks for years 2008 and 2009. Gombac referred to a spreadsheet outlining that if the City has 16 leaks the cost for the program could be approximately an additional \$4,720 dollars for a total of approximately \$14,240. Should more leaks

be identified the proposal is capped at a not to exceed \$14,208.48. The Staff had negotiated the capped limits with ATS and they have agreed to the limits for the City as well as the County SERF system. Gombac informed the Committee that staff does anticipate finding leaks, but the amount will not be known until the leak survey is completed. Further he stated that the annual water accountability report has increased approximately 1.6% per year since 2008.

The City entertained competitive leak detection quotes for the City's water system and the DuPage County SERF water system. It was the intention of the quote to obtain potential volume pricing and to engage a single vendor for both systems due to the proximity and interconnections of the two systems. This will provide consistency and continuity for both the City and the County. The City and the County worked together to formulate the quote request. In addition, both parties have reviewed the quote results and concur with the prices submitted by ATS.

Mr. Gombac reported City staff had invited three vendors for competitive quotes and received two. ATS had a mathematical error in their proposal for DuPage County and was adjusted as presented. Based on the detection phase ATS is the lowest competitive quote for both agencies. Staff had contacted ATS to meet the price of the alternative vendor for the City portion detection phase and they have agreed to meet the competitors pricing schedule. The County and City staffs feel that ATS has provided very satisfactory services in the past and is highly recommended.

Alderman Galan questioned what the average cost is of one leak. He stated that he prefers to have a dollar amount noted.

Mr. Gombac reported that he would update the report with a dollar cost and share the information with the Committee.

There was no one in the audience wishing to present public comment.

Alderman Schauer made a motion and it was seconded by Alderman Galan to approve a RESOLUTION AUTHORIZING THE MAYOR TO ACCEPT A PROPOSAL FROM ASSOCIATED TECHNICAL SERVICES (ATS), FOR THE 2010-11 WATER LEAK SURVEY IN AN AMOUNT NOT TO EXCEED \$14,208.48.

Upon voice vote, THE MOTION CARRIED unanimously 3-0.

G. Resolution – A Resolution to execute a three year Intergovernmental Agreement with the County of DuPage for mowing along County roads and right of ways.

Mr. Dan Gombac, Director reported that the resolution authorizes an Intergovernmental Agreement with DuPage County for the City of Darien to perform the mowing of certain DuPage County right of ways. He further informed the Committee that Staff had requested additional funding from the County and the County responded that the proposal was fair and would not entertain additional funding to the City. The County had conducted a mowing cost summary in 2008 that supported their fair share.

There was no one in the audience wishing to present public comment.

Alderman Galan made a motion and it was seconded by Alderman Schauer to approve A RESOLUTION AUTHORIZING THE MAYOR AND THE CITY CLERK TO EXECUTE AN INTERGOVERNMENTAL AGREEMENT BETWEEN THE CITY OF DARIEN AND THE COUNTY OF DUPAGE FOR MOWING ALONG COUNTY ROAD AND RIGHT OF WAYS.

Upon voice vote, THE MOTION CARRIED unanimously 3-0.

H. Minutes – January 24, 2011 – Municipal Services Committee Meeting

Alderman Schauer made a motion and it was seconded by Alderman Galan to approve the January 24, 2011 Municipal Services Committee Meeting Minutes.

Upon voice vote, THE MOTION CARRIED unanimously 3-0.

DIRECTOR'S REPORT

a. Hydrant Markers

Mr. Dan Gombac, Director reported that Alderman Galan and Alderman Poteraske requested a discussion regarding fire hydrant markers. He reported that the cost for markers would be approximately \$30,000. The hydrant markers would be installed once and remain in place year round.

He stated that the level of concern came up due to the historic snow storm event and Gombac commented that while hydrants were buried staff had made the necessary arrangements to unbury the hydrants within 72 hours after the storm. Residents and the fire departments also helped unbury the hydrants.

Alderman Galan stated that \$30,000 was a very expensive solution for a snow fall which may not happen for another ten years. The Committee had concurred with not moving forward with the discussion. Alderman Galan requested that the comments be shared with the City Council.

Alderman Schauer questioned when the last time the hydrants were painted.

Mr. Gombac reported that the hydrants were last painted 10 years ago and that the cost to repaint them has been estimated at approximately \$145,000. This item was not considered for this year's budget.

Alderman Schauer suggested looking at purchasing hydrant markers after the hydrants are painted.

Mr. Gombac reported that at the last budget meeting that there were two items that were not discussed and are being presented into the final draft budget. The items relate to equipment for the water division in the amount of \$21,000.

Under general comments Chairperson Marchese stated that the Committee needs to consider presenting the Public Works replacement vehicles to the City Council as the Police Department presents. The Police Department presents the vehicles as a fleet package.

Alderman Galan suggested looking into fleet leasing as an alternative. He stated that the Police Department does this and it works well.

Mr. Gombac informed the Committee that he would look into the recommendation, and informed the Committee that the Departments fleet would need to be categorized into different categories such as light and medium duty.

NEXT MEETING

Chairperson Marchese announced that the next scheduled meeting will be held on Monday, March 28, 2011 at 6:30 p.m.

ADJOURNMENT

There being no other business before the Committee, Alderman Galan made a motion and it was seconded by Alderman Schauer to adjourn. Upon voice vote, **THE MOTION CARRIED unanimously and the meeting adjourned at 7:45 p.m.**

RESPECTFULLY SUBMITTED:

APPROVED:

Elizabeth Lahey
Secretary

Joseph Marchese
Chairperson

John Galan
Alderman

Ted Schauer
Alderman

**MINUTES
CITY OF DARIEN
SPECIAL MEETING
MUNICIPAL SERVICES COMMITTEE MEETING
April 11, 2011**

PRESENT: Alderman Joseph Marchese - Chairman, Alderman John Galan, Alderman Ted Schauer, Dan Gombac-Director, Elizabeth Lahey-Secretary

ABSENT: None

OTHERS: Mayor Kathleen Weaver

Chairperson Marchese called the Municipal Services Committee Special Meeting to order at 6:00 p.m. at City Hall – City Council Chambers, Darien, Illinois and declared a quorum present.

MEETING:

- A. PZC 2011-04: 7511 Lemont Road, Chestnut Court Shopping Center, Oakridge Hobbies: Petitioner seeks a variation from the Sign Code to permit a greater amount of wall signage than permitted by the Sign Code.**

Mr. Dan Gombac, Director presented the staff report. He stated that the petitioner is seeking a variation from the Sign Code in a B-3 Retail Shopping Use.

Mr. Gombac noted the spreadsheet on page two of the Agenda Memo showing the existing sign compared to the JoAnn Fabrics sign. He referenced the storyboards from the petitioner showing the front and side facade.

Mr. Gombac referenced the memo in the Agenda Memo from Jeffrey A. Howard supporting the sign variance. He also stated that this request did not warrant a public hearing and that staff supports the sign variation. Mr. Gombac stated that Oakridge Hobbies is not a national tenant but a business which will capture clients. He stated that the PZC voted favorably 5-0 and that Mayor Kathleen Weaver presented public comment in support of the petition.

Alderman Galan questioned the tower color.

Mr. Gombac noted that the tower will be red and referenced the storyboard.

Alderman Schauer questioned if Inland was supporting this petition.

Mayor Kathleen Weaver stated that Inland was 100% supportive.

Alderman Schauer stated that the building looks beautiful. He stated that he hopes that this will draw in business.

Chairperson Marchese stated that he was extremely pleased with the outcome.

Mr. Gombac stated that the lighting was reviewed and is within the Code.

There was no one in the audience wishing to present public comment.

Alderman Schauer made a motion and it was seconded by Alderman Galan that based upon the submitted petition and the information presented, the request associated with PZC 2011-04 is in conformance with the standards of the Darien City Code and move that the Municipal Services Committee recommend to the City Council approval of the petition as presented.

Upon voice vote, THE MOTION CARRIED unanimously 3-0.

Alderman Marchese announced this would be forwarded to the City Council on Monday, April 18th.

ADJOURNMENT:

With no further business before the Committee, Alderman Galan made a motion and it was seconded by Alderman Schauer. Upon voice vote, THE MOTION CARRIED unanimously and the meeting adjourned at 6:07 p.m.

RESPECTFULLY SUBMITTED:

APPROVED:

Elizabeth Lahey
Secretary

Joseph Marchese
Chairperson

John Galan
Alderman

Ted Schauer
Alderman

Ashley Prueter

From: Dan Gombac
Sent: Tuesday, March 15, 2011 11:52 AM
To: Ashley Prueter
Subject: RE: FYI

please include for the 28th ms, dir report

Chromium 6 article

Daniel Gombac
Director of Municipal Services
630-353-8106

From: Ashley Prueter
Sent: Tuesday, March 15, 2011 11:04 AM
To: Ashley Prueter; Dan Gombac; Bryon Vana; Scott Coren
Subject: RE: FYI

Helps it I attach it.

Ashley Prueter
City of Darien Municipal Services
630-353-8105

From: Ashley Prueter
Sent: Tuesday, March 15, 2011 11:03 AM
To: Dan Gombac; Bryon Vana; Scott Coren
Subject: FYI

Article in current Water World regarding Chromium 6 if your interested.

Ashley Prueter
City of Darien Municipal Services
630-353-8105

WaterWorld

Serving the Municipal Water/WasteWater Industry • www.waterworld.com

March 2011

Key Features

14 Penn Tips

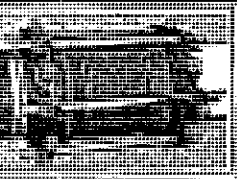

53 Penn

55 Membranes & Related Products

61 Bulletin Board

62 Case Study

New Advanced Monitoring Analytics System

The system integrates your existing data and feeds it into a powerful analytics engine, providing a clear and concise view of your water quality data. This system is designed to help you identify trends and anomalies in your water quality data, allowing you to take proactive measures to maintain the highest quality of water for your customers.

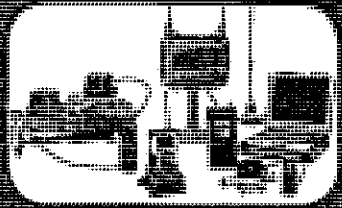

EPA Studies Regulation of Hexavalent Chromium

By Dr. Andrew Eaton

Hexavalent chromium, the contaminant made popular in the Julia Roberts movie *Erin Brockovich*, has been a hot topic both within the water industry and among the public in recent months following a report in December by an environmental group showing the presence of the contaminant in 35 U.S. cities' water supplies.

While the presence of hexavalent chromium, also called chromium 6, in U.S. drinking waters comes as no surprise, the report and the public reaction it drew prompted the EPA to recommend utilities across the U.S. begin voluntary monitoring for hexavalent chromium.

So, what do utilities and others need to know about the contaminant, and what else are utilities likely to see regulation on in the near future?

Background

Hexavalent chromium in most drinking supplies originates from natural sources. Chromium is naturally occurring in many rocks, and hexavalent chromium is generally the stable form in water. There is much debate about the levels at which hexavalent chromium poses a public health threat, with levels up to 10 parts per billion (ppb) being fairly common in cities that do the testing. Regulatory compliance monitoring for total chromium showed that more than 15% of water supplies have over 10 ppb. In Hinkley, Calif., where *Erin Brockovich* came to notoriety, levels were reported at 580 ppb (over 5 times the current allowable level for total chromium) and tied to industrial activities by the Pacific Gas and Electric facility.

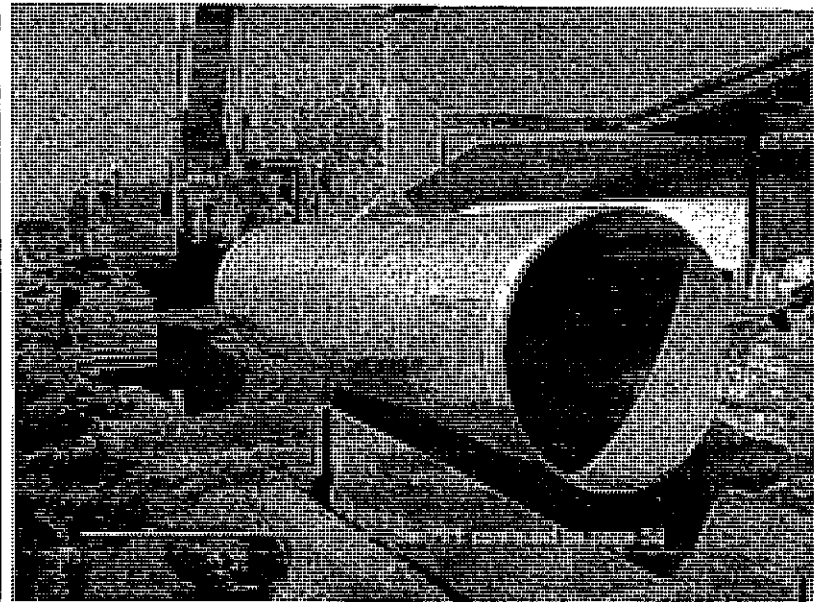

The presence of hexavalent chromium in U.S. drinking waters is not a new revelation. The EPA has had standards for total chromium in place for over a decade, and there is evidence that the majority of total chromium in water supplies is hexavalent chromium. California utilities have tested for it for a decade and more than 65% of samples have had hexavalent chromium over 1 ppb.

The Environmental Working Group (EWG) released a report on Dec. 20 revealing the presence of hexavalent chromium (Cr+6) in drinking water from 35 utilities around the country. The cities with the highest levels were Norman, Okla., which was reported to have levels at 12 parts per billion (ppb), and Honolulu, which was reported to have levels at 2 ppb.

Until the EWG report, there was limited public attention to hexavalent chromium in drinking water in California and the rest of the country. The media attention garnered by the EWG report changed that, prompting the EPA to encourage utilities to begin testing for hexavalent chromium on a voluntary basis.

See COVER FEATURE continued on page 32

DAN GOMBAC
DIRECTOR
DEPARTMENT OF PUBLIC WORKS
1702 PLAINFIELD RD
DARIEN, IL 60561-5044

#BXNMSSM *****ALTO**3-DIGIT 605
#0567584/CB/9# 001 S025400309

Expected results of nationwide testing

We can expect utilities that do take the EPA's guidance to find hexavalent chromium in their water supplies.

California utilities have tested for chromium 6 for a decade, under the

the water has been disinfected, it is likely that even most trivalent chromium will be converted to hexavalent chromium. Research conducted by MWH Laboratories in 2001 (Eaton et al, 2001, "The Erin Brockovich Factor"), and presented at the

Figure 1. Potential MRLs to be regulated under the "strong" scenario.

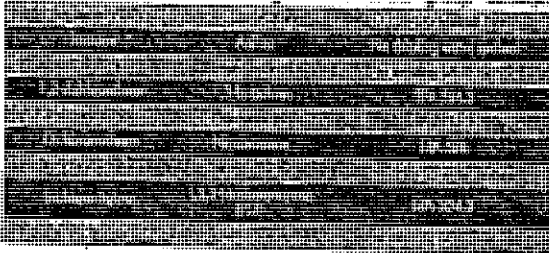

Water Quality Technology Conference demonstrated that parallel measurements of hexavalent chromium and total chromium showed most samples to be essentially 100 percent hexavalent chromium.

The EPA currently has a maximum contaminant level for total chromium and has indicated that further regulation is likely.

Testing Methods

Following the release of the EWG report, the EPA recommended extensive "voluntary monitoring" of hexavalent chromium in source, finished water and distribution system sites, using the most sensitive method, EPA 218.6, which is an ion chromatography-post column reaction method. When method 218.6 was first released, it had a published method reporting limit (MRL) of 0.4 ppb. California used a more conservative reporting limit of 1 ppb, but

Figure 2. Likely requirements by UCMR and associated analytical method



within a year of passing the California UCMR, the method was revised by instrument vendors to achieve a much greater sensitivity based on the then proposed PHG of 0.2 ppb.

Based on the method revision, the EPA recommended that utilities use an MRL of 0.06 ppb for the voluntary monitoring. Method 218.6 has a nominal holding time of 24 hours, but the regulations allow a holding time of up to 28 days, provided the sample has been properly buffered. Based in part on the data presented in 2001, along with newer holding time tests performed by CDFPH and MWH Laboratories, the EPA in its January call for voluntary testing allowed a holding time of five days until the agency could revisit the method.

Testing Protocol Not Defined

Many unanswered questions remain about the voluntary testing of hexavalent chromium and what further action the EPA may take.

So far it is unclear how data collected by utilities will be used. The American Water Works Association (AWWA) has recommended that EPA create a database for housing results of the recommended monitoring and how

approached the EPA regarding potential ways to capture the data. EPA is currently reluctant to capture the data because it is a voluntary monitoring program and it would thus be "selective" data capture.

It also is unclear how utilities will be asked to respond when they detect hexavalent chromium in drinking supplies. The EPA is expected to issue further guidance on public notification, including what information to include. Based on the existing occurrence data, it is likely that most utilities conducting monitoring will detect hexavalent chromium, both because of the sensitivity of the method and the ubiquitous occurrence of chromium in rocks. Utilities may choose to disclose whether or not their drinking water meets Safe Drinking Water Act (SDWA) requirements based on total chromium.

Due to the increased public awareness of the issue, it may be worthwhile for utilities to provide the public with context. For example, California set a final public health goal for arsenic of 0.004 ppb, but the state and federal maximum contaminant level (MCL) is still 10 ppb. Currently, the proposed PHG for hexavalent chromium is 0.02 ppb, five times higher than arsenic, so levels comparable to those reported by EWG would still be considered low when comparing the PHG to the MCL.

Other Testing Considerations

There has been some concern over the potential for false positives resulting from leaching of chromium from stainless steel. When measuring at the ultralow levels specified by the EPA, contamination from sources such as sampling devices is always a possibility. So far there does not appear to be any data indicating this to be a significant risk. When measuring at sub-ppb levels, caution is critical. It would most likely be an issue if the taps showed signs of corrosion. A quick way to evaluate the potential would be to sample both a first draw (if taps are not always on) and one after letting the water run for 5 to 10 minutes. The advantage of the multiple sampling points recommended by EPA is the ability to look for consistency in results among sites as a guide to know whether investigation is warranted.

LTRWC
CALDWELL
 Superior Craftsmanship
 Past, Present and Future

...we are committed to providing the highest quality of service to our customers...

...we are committed to providing the highest quality of service to our customers...

...we are committed to providing the highest quality of service to our customers...